

Specjalistyczne okucia meblowe[®]

Global
Service



2017

Specjalistyczne okucia meblowe

Global Service

Założona w 2006 roku firma Global Service wypełnia lukę na rynku okuć technicznych. Zajmujemy się dystrybucją specjalistycznych rozwiązań dla przemysłu meblarskiego na rynek polski i na rynki krajów sąsiednich. Większość naszych produktów jest wyprodukowanych w Europie, dzięki czemu możemy zaoferować: szybkość realizacji zamówień, wysoką jakość produktów i stabilność cen.

Dzięki bezpośredniej współpracy z producentami przygotowujemy na specjalne zamówienia klientów wyroby niestandardowe - charakteryzujące się specjalnym materiałem, długością bądź wykończeniem. Wszystkie produkty są testowane pod względem zastosowanych materiałów i powłok ochronnych. Posiadamy magazyn na północy Polski – do realizacji zamówień w ciągu 24 godzin na terenie całego kraju.

Zapraszamy do zapoznania się z naszą ofertą!

Global Service is a company founded in 2006. Our aim is to fill the current gap in the market for technical fittings in the furniture industry. We are a distributor that specializes in finding solutions for the furniture industries in Poland and neighbouring countries. Many of our products are produced in Europe enabling us to process transactions quickly and to offer the highest quality and stability of prices.

Through direct cooperation with the producers we are able to offer customers products that are made out of particular materials, have different lengths or finishings.

We ensure that all our products and materials have been tested and have a protecting coating. Our stock is located in the North of Poland – this allows us to deliver to anywhere in Poland within 24 hours.

| | |
|---|---|
|  | WOOD SCREWS WKRĘTY DO DREWNA |
|  | METAL SCREWS WKRĘTY DO METALU |
|  | INSERT NUTS SLEEVE NUTS MUFY DO DREWNA NAKRĘTKI ERICSONA |
|  | CONNECTING FITTINGS SYSTEMY POŁĄCZEŃ |
|  | ADJUSTABLE LEGS REGULATORY |
|  | SHELF SUPPORTS PODPÓRKI |
|  | OTHERS POZOSTAŁE |

WKRETY DO DREWNA

EURO SCREWS flat head
WKRETY EURO z łbem stożkowym

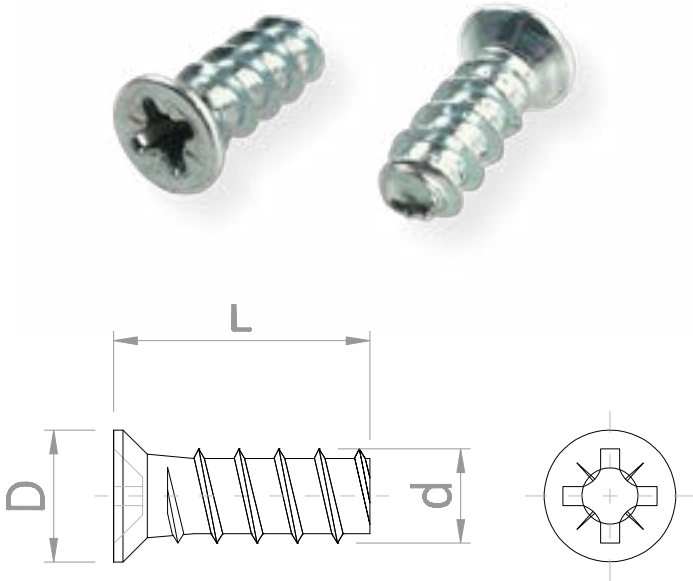

| Art. | D [mm] | d [mm] | L [mm] |
|-----------|--------|--------|--------|
| 18.053.9 | 7.0 | 5.0 | 9.0 |
| 18.053.11 | 7.0 | 5.0 | 11.0 |
| 18.053.13 | 7.0 | 5.0 | 13.0 |
| 18.050.8 | 7.0 | 6.0 | 8.0 |
| 18.050.95 | 7.0 | 6.0 | 9.5 |
| 18.050.11 | 7.0 | 6.0 | 11.5 |
| 18.050.13 | 7.0 | 6.0 | 13.0 |
| 18.050.20 | 7.0 | 6.0 | 20.0 |
| 18.051.95 | 8.0 | 6.3 | 9.5 |
| 18.051.11 | 8.0 | 6.3 | 11.5 |
| 18.051.13 | 8.0 | 6.3 | 13.0 |
| 18.051.16 | 8.0 | 6.3 | 16.0 |
| 18.051.20 | 8.0 | 6.3 | 20.0 |
| 18.051.24 | 8.0 | 6.3 | 24.0 |

EURO SCREWS pan head
WKRETY EURO z łbem walcowym



| Art. | D [mm] | d [mm] | L [mm] |
|-----------|--------|--------|--------|
| 18.052.11 | 9.3 | 6.3 | 11.5 |
| 18.052.13 | 9.3 | 6.3 | 13.0 |
| 18.052.16 | 9.3 | 6.3 | 16.0 |
| 18.052.20 | 9.3 | 6.3 | 20.0 |
| 18.052.24 | 9.3 | 6.3 | 24.0 |
| 18.052.30 | 9.3 | 6.3 | 30.0 |

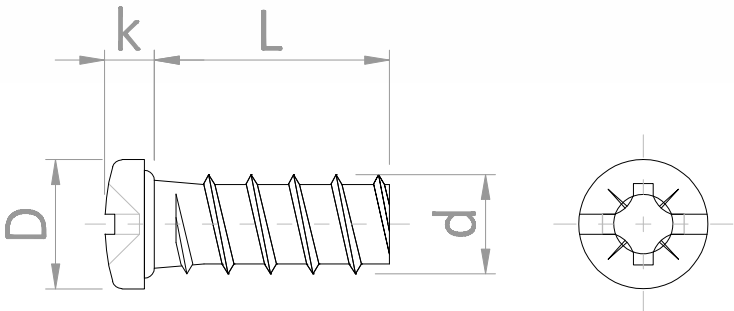

CONFIRMAT SCREWS hex socket flat head
WKRETY KONFIRMAT z wgłębieniem imbusowym

| Art. | D [mm] | d [mm] | s [mm] | L [mm] |
|--------|--------|--------|--------|--------|
| 18.001 | 9.5 | 6.4 | 4 | 50 |
| 18.003 | 10.5 | 7.0 | 4 | 50 |
| 18.004 | 10.5 | 7.0 | 4 | 70 |

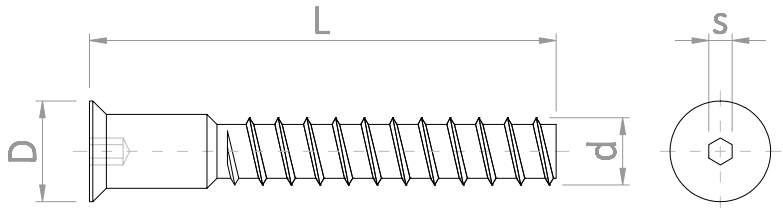

CHIPBOARD SCREWS button head
WKRETY DO DREWNA z podkładką

| d [mm] | 3.0 [mm] | 3.5 [mm] | 4.0 [mm] | 5.0 [mm] |
|--------|----------|----------|----------|----------|
| D [mm] | 7.0 | 8.0 | 9.0 | 12.0 |
| k [mm] | 1.6 | 1.8 | 2.0 | 2.6 |
| L [mm] | 18.120 | 18.121 | 18.122 | 18.124 |
| 10 | | | | |
| 12 | | | • | |
| 13 | • | • | • | |
| 16 | • | • | • | |
| 20 | • | • | • | • |
| 25 | | • | • | • |
| 27 | | | • | |
| 30 | • | • | • | |
| 35 | | | • | • |
| 40 | | • | | |
| 45 | | | • | • |
| 50 | | | • | • |
| 60 | | | | • |
| 70 | | | | • |

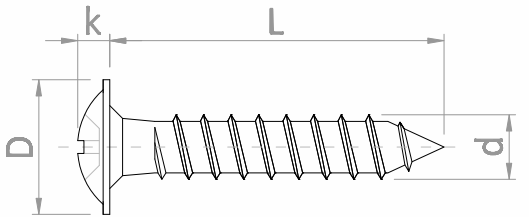
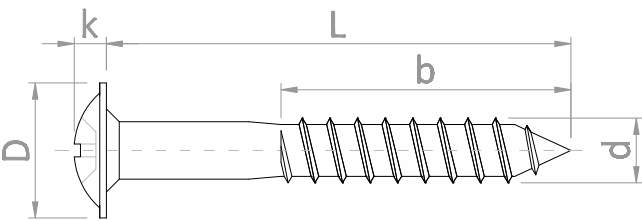

CHIPBOARD SCREWS flat head
WKRETY STOŻKOWE płaski łeb

| d [mm] | 3.0 [mm] | 3.5 [mm] | 4.0 [mm] | 4.5 [mm] | 5.0 [mm] | 6.0 [mm] |
|--------|----------|----------|----------|----------|----------|----------|
| D [mm] | 6.0 | 7.0 | 8.0 | 9.0 | 10.0 | 12.0 |
| L [mm] | 18.100 | 18.101 | 18.102 | 18.103 | 18.104 | 18.105 |
| 10 | • | • | | | | |
| 12 | • | | • | | | |
| 13 | • | • | • | | | |
| 16 | • | • | • | • | • | |
| 20 | • | • | • | • | • | |
| 25 | • | • | • | • | • | |
| 30 | • | • | • | • | • | |
| 35 | • | • | • | • | • | |
| 40 | | • | • | • | • | • |
| 45 | | • | • | | • | |
| 50 | | | • | • | • | • |
| 60 | | • | • | • | • | • |
| 70 | | | • | • | • | |
| 80 | | | • | | • | |

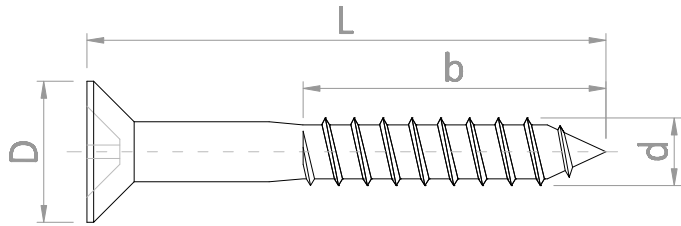
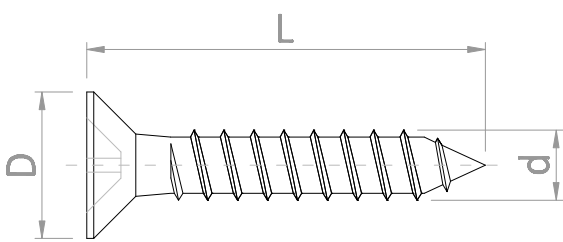

WOOD SCREWS torx drive
WKRETY DO DREWNA nacięcie torx

| d [mm] | 3.0 [mm] | 3.5 [mm] | 4.0 [mm] | 4.5 [mm] | 5.0 [mm] | 6.0 [mm] |
|--------|----------|----------|----------|----------|----------|----------|
| TORX | TX 10 | TX 15 | TX 20 | TX 20 | TX 25 | TX 30 |
| L [mm] | 18.060 | 18.061 | 18.062 | 18.063 | 18.064 | 18.065 |
| 30 | • | • | | | | |
| 35 | • | • | • | | | |
| 40 | • | • | • | • | • | |
| 45 | | | • | | | |
| 50 | | • | • | • | • | • |
| 60 | | | • | • | • | • |
| 70 | | | • | • | • | • |
| 80 | | | | • | • | • |
| 90 | | | | | • | • |
| 100 | | | | | • | • |
| 120 | | | | | • | • |
| 140 | | | | | | • |
| 160 | | | | | | • |
| 180 | | | | | | • |
| 200 | | | | | | • |

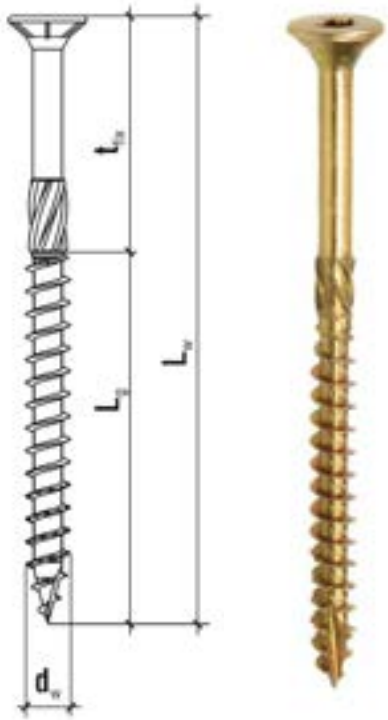

WOOD SCREWS with button torx drive
WKRETY DO DREWNA Z PODKŁADKĄ nacięcie torx

| d [mm] | 6.0 [mm] | 8.0 [mm] |
|--------|----------|----------|
| TORX | TX 30 | TX 40 |
| L [mm] | 18.070 | 18.071 |
| 50 | • | |
| 60 | • | |
| 70 | • | |
| 80 | • | • |
| 90 | • | |
| 100 | • | • |
| 120 | • | • |
| 140 | • | • |
| 160 | • | • |
| 180 | • | • |
| 200 | • | • |
| 220 | | • |
| 240 | | • |
| 260 | | • |
| 280 | | • |
| 300 | | • |

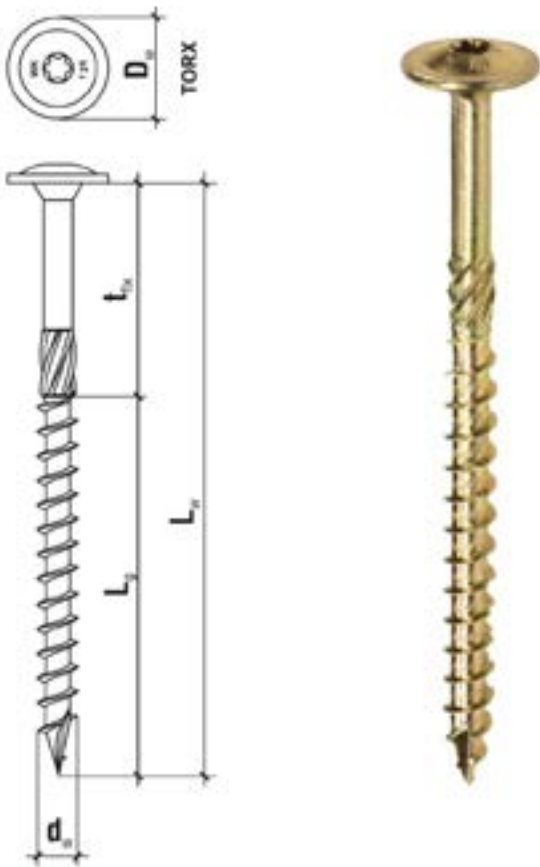

WKRETY DO DREWNA

WOOD SCREWS hex drive
WKRETY DO DREWNA z nacięciem imbusowym

| Art. | D [mm] | d [mm] | s [mm] | k [mm] | L [mm] |
|------------|--------|--------|--------|--------|--------|
| 562A063030 | 14.5 | 6.3 | 4 | 2.9 | 30 |
| 562A063040 | 14.5 | 6.3 | 4 | 2.9 | 40 |
| 562A063050 | 14.5 | 6.3 | 4 | 2.9 | 50 |
| 562A063060 | 14.5 | 6.3 | 4 | 2.9 | 60 |
| 562A063070 | 14.5 | 6.3 | 4 | 2.9 | 70 |
| 562A063080 | 14.5 | 6.3 | 4 | 2.9 | 80 |
| 562A063090 | 14.5 | 6.3 | 4 | 2.9 | 90 |
| 562A063100 | 14.5 | 6.3 | 4 | 2.9 | 100 |
| 562A063110 | 14.5 | 6.3 | 4 | 2.9 | 110 |
| 562A063120 | 14.5 | 6.3 | 4 | 2.9 | 120 |

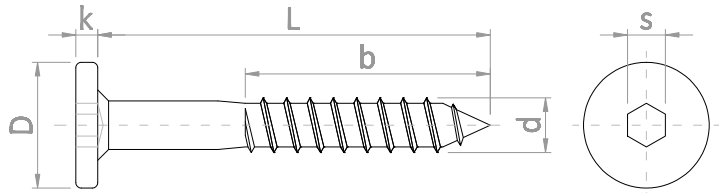

HEXAGON NUTS
NAKRETKI SZEŚCIOKĄTNE

| Art. | d [mm] | s [mm] | e [mm] | w [mm] |
|-----------|--------|--------|--------|--------|
| 19.050.5 | M5 | 8.0 | 8.87 | 4.0 |
| 19.050.6 | M6 | 10.0 | 11.05 | 5.0 |
| 19.050.8 | M8 | 13.0 | 14.38 | 6.5 |
| 19.050.10 | M10 | 17.0 | 18.90 | 8.0 |

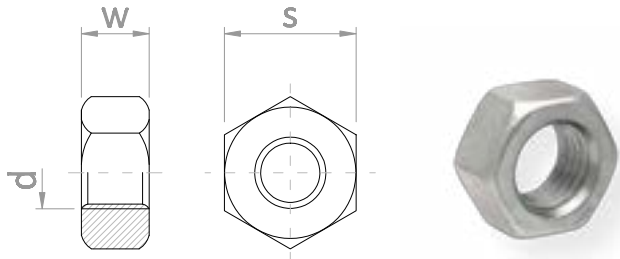

HEXAGON NUTS with nylon insert
NAKRETKI SZEŚCIOKĄTNE samokontrolujące

| Art. | d [mm] | s [mm] | e [mm] | w [mm] |
|-----------|--------|--------|--------|--------|
| 19.053.6 | M6 | 10.0 | 11.05 | 6.0 |
| 19.053.8 | M8 | 13.0 | 14.38 | 8.0 |
| 19.053.10 | M10 | 17.0 | 18.90 | 10.0 |

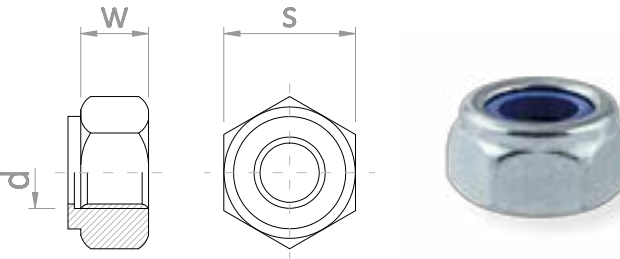

WOOD SCREWS hex head
WKRETY DO DREWNA z łbem sześciokątnym

| d [mm] | 6.0 [mm] | 8.0 [mm] | 10.0 [mm] | 12.0 [mm] |
|--------|----------|----------|-----------|-----------|
| s [mm] | 10 | 13 | 17 | 19 |
| k [mm] | 4.0 | 5.3 | 7.0 | 8.0 |
| L [mm] | 18.206 | 18.208 | 18.210 | 18.212 |
| 30 | • | | | |
| 40 | • | • | | |
| 50 | | • | | |
| 60 | • | • | • | |
| 70 | | • | • | |
| 80 | • | • | • | |
| 90 | • | | | |
| 100 | • | • | • | • |
| 120 | • | • | • | • |
| 140 | • | • | | |
| 160 | | | • | • |
| 180 | | | • | |
| 200 | | | | • |
| 220 | | | | • |



STEEL WASHERS
PODKŁADKI STALOWE

| Art. | d [mm] | D [mm] | S [mm] |
|-----------|--------|--------|--------|
| 19.048.6 | 6.6 | 12.0 | 1.6 |
| 19.048.8 | 9.0 | 16.0 | 1.6 |
| 19.048.10 | 11.0 | 20.0 | 2.0 |
| 19.048.12 | 13.5 | 24.0 | 2.4 |
| 19.055.5 | 5.3 | 15.0 | 1.2 |
| 19.055.6 | 6.4 | 18.0 | 1.5 |
| 19.055.8 | 8.4 | 24.0 | 2.0 |
| 19.055.10 | 10.5 | 30.0 | 2.3 |
| 19.052.8 | 9.0 | 28.0 | 3.0 |
| 19.052.10 | 11.0 | 34.0 | 3.0 |

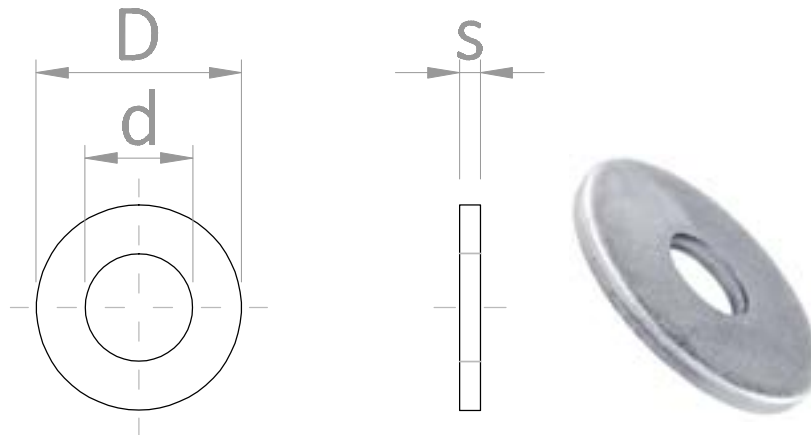

WKRETY DO METALU

METAL SCREWS full thread with hexagon head
ŚRUBY MASZYNOWE z pełnym gwintem i łbem sześciokątnym kl. 5.8

METAL SCREWS partial thread with hexagon head
ŚRUBY MASZYNOWE z niepełnym gwintem i łbem sześciokątnym kl. 5.8

| d | M6 | M8 | M10 | M12 |
|--------|----------|----------|----------|----------|
| S [mm] | 10 | 13 | 17 | 19 |
| k [mm] | 4 | 5,5 | 7 | 8 |
| L [mm] | 402A0060 | 402A0080 | 402A0100 | 402A0120 |
| 14 | | • | | |
| 16 | • | • | • | |
| 20 | • | • | • | • |
| 25 | • | • | • | • |
| 30 | • | • | • | • |
| 35 | • | • | • | • |
| 40 | • | • | • | • |
| 45 | • | • | • | • |
| 50 | • | • | • | • |
| 55 | • | • | • | • |
| 60 | • | • | • | • |
| 65 | • | • | • | • |
| 70 | • | • | • | • |
| 80 | • | • | • | • |
| 90 | • | • | • | • |
| 100 | • | • | • | • |
| 105 | • | | | |
| 120 | | • | • | |

| d | M6 | M8 | M10 | M12 |
|--------|----------|----------|----------|----------|
| S [mm] | 10 | 13 | 17 | 19 |
| k [mm] | 4 | 5,5 | 7 | 8 |
| L [mm] | 402C1060 | 402C1080 | 402C1100 | 402C1120 |
| 40 | • | • | • | • |
| 45 | • | • | | • |
| 50 | • | • | • | • |
| 60 | • | • | • | • |
| 70 | • | • | • | • |
| 80 | • | • | • | • |
| 90 | • | • | • | • |
| 100 | • | • | • | • |
| 110 | • | • | • | • |
| 120 | • | • | • | • |
| 130 | • | • | • | • |
| 140 | • | • | • | • |
| 150 | • | • | • | • |
| 160 | | | • | • |
| 170 | | | • | |
| 180 | | | • | • |
| 200 | | | | • |

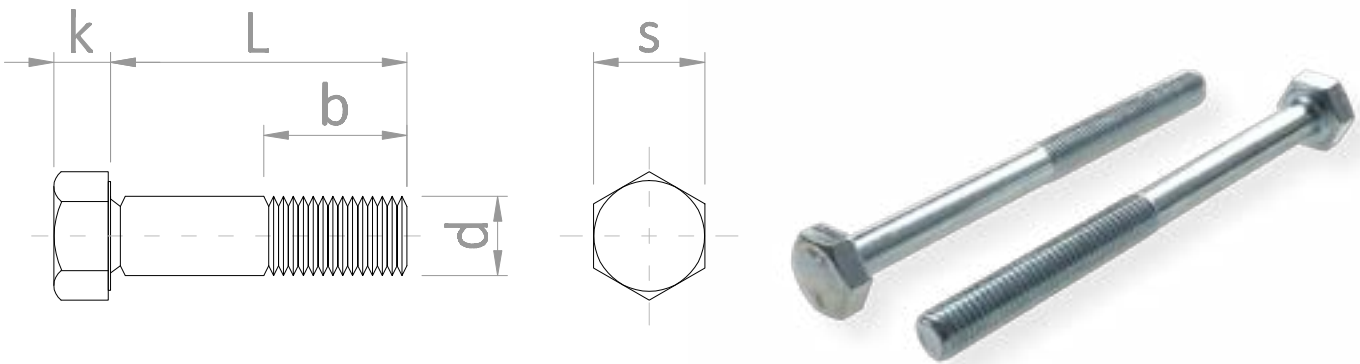
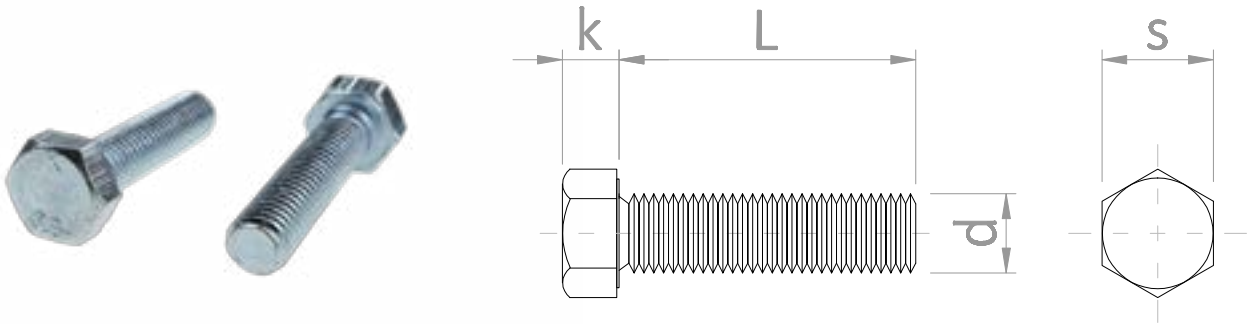

METAL SCREWS with round head square neck
ŚRUBY ZAMKOWE z łbem kulistym i podsadzeniem

THREADED BARS
TRZPIENIE GWINTOWANE

| d | M5 | M6 | M8 | M10 | M12 |
|--------|----------|----------|----------|----------|----------|
| D [mm] | 13 | 16 | 20 | 24 | 30 |
| S [mm] | 5 | 6 | 8 | 10 | 12 |
| k [mm] | 3 | 3,5 | 5 | 6 | 8 |
| L [mm] | 407A0050 | 407A0060 | 407A0080 | 407A0100 | 407A0120 |
| 12 | | • | | | |
| 15 | | • | | | |
| 16 | • | • | • | | |
| 20 | • | • | • | | |
| 25 | • | • | • | • | • |
| 30 | • | • | • | • | • |
| 32 | | • | | | |
| 35 | • | • | • | • | • |
| 40 | • | • | • | • | • |
| 45 | • | • | • | • | • |
| 50 | • | • | • | • | • |
| 55 | • | • | • | • | • |
| 60 | • | • | • | • | • |
| 65 | | • | • | | |
| 70 | | • | • | • | • |
| 75 | | • | • | | |
| 80 | | • | • | • | • |
| 85 | | • | • | | |
| 90 | | • | • | • | • |
| 95 | | • | | | |
| 100 | | • | • | • | • |
| 105 | | • | | | |
| 110 | | • | • | • | • |
| 120 | | • | • | • | • |
| 130 | | • | • | • | • |
| 140 | | • | • | • | • |
| 150 | | • | • | • | • |
| 160 | | | • | • | • |
| 180 | | | | • | • |
| 200 | | | | • | • |
| 220 | | | | • | • |
| 240 | | | | | • |

| d | M6 | M8 | M10 |
|--------|----------|----------|----------|
| L [mm] | 401A0060 | 401A0080 | 401A0100 |
| 30 | • | • | |
| 35 | • | | |
| 40 | • | • | |
| 60 | | • | • |
| 70 | • | • | • |
| 80 | | • | • |
| 90 | | • | |
| 100 | | • | • |
| 110 | | • | • |
| 120 | • | • | |
| 130 | | • | |
| 140 | | • | |

| Art. | d | Ø [mm] | d [mm] | l [mm] |
|------------|-----|--------|--------|--------|
| 400H106050 | M6 | 6,3 | 25 | 50 |
| 400H108050 | M8 | 8,5 | 25 | 50 |
| 400H108060 | M8 | 8,5 | 30 | 60 |
| 400H108070 | M8 | 8,5 | 35 | 70 |
| 400H108080 | M8 | 8,5 | 40 | 80 |
| 400H110060 | M10 | 10,7 | 30 | 60 |
| 400H110080 | M10 | 10,7 | 40 | 80 |

| Art. | d | s | a [mm] | d [mm] | l [mm] |
|------------|-----|---|--------|--------|--------|
| 18.308.60 | M8 | 6 | 15 | 30 | 60 |
| 18.308.70 | M8 | 6 | 15 | 39 | 70 |
| 18.308.80 | M8 | 6 | 15 | 44 | 80 |
| 18.308.90 | M8 | 6 | 25 | 49 | 90 |
| 18.308.100 | M8 | 6 | 25 | 49 | 100 |
| 18.308.120 | M8 | 6 | 50 | 59 | 120 |
| 18.310.60 | M10 | 8 | 15 | 35 | 60 |
| 18.310.70 | M10 | 8 | 25 | 30 | 70 |
| 18.310.80 | M10 | 8 | 19 | 49 | 80 |
| 18.310.100 | M10 | 8 | 30 | 49 | 100 |
| 18.310.120 | M10 | 8 | 37 | 59 | 120 |

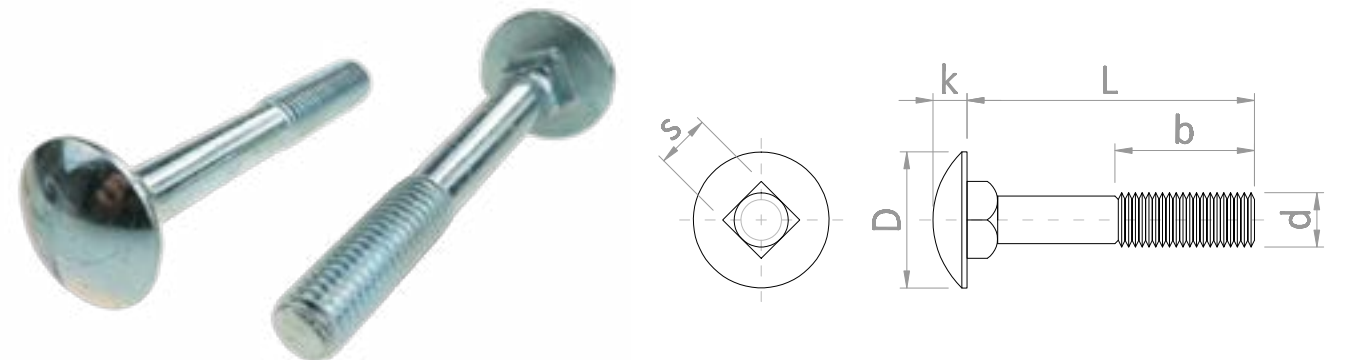
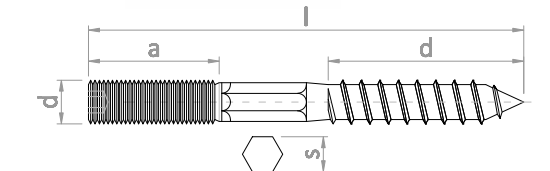
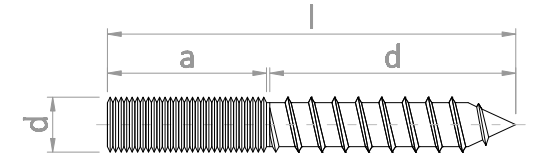
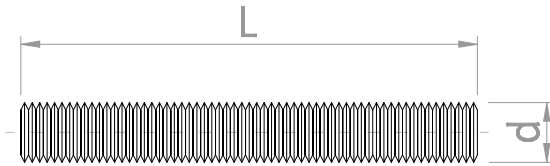

METRIC SCREWS with pan head
WKRETY METRYCZNE z łbem walcowym

METRIC SCREWS flat head, PZD drive
WKRETY METRYCZNE z łbem stożkowym, nacięcie PZD

WKRETY DO METALU



| d | M3 | M4 | M5 | M6 | M8 | M10 |
|---------|----------|----------|----------|----------|----------|-----------|
| D [mm] | 5,6 | 8 | 9,5 | 12 | 16 | 20 |
| k [mm] | 2,4 | 3,1 | 3,7 | 4,6 | 6 | 7,5 |
| PZ [mm] | 1 | 2 | 2 | 3 | 4 | 4 |
| L [mm] | 420A0030 | 420A0040 | 420A0050 | 420A0060 | 420A0080 | 420A01000 |
| 5 | • | | | | | |
| 6 | • | | | | | |
| 8 | • | • | • | • | | |
| 10 | • | • | • | • | | |
| 12 | • | • | • | • | | |
| 14 | | • | • | • | | |
| 16 | | • | • | • | • | |
| 18 | | • | • | • | • | |
| 20 | | • | • | • | • | • |
| 25 | | • | • | • | • | • |
| 30 | | • | • | • | • | • |
| 35 | | • | • | • | • | • |
| 40 | | • | • | • | • | • |
| 45 | | | • | • | • | • |
| 50 | | | • | • | • | • |
| 55 | | | • | • | • | • |
| 60 | | | • | • | • | • |
| 65 | | | | • | • | • |
| 70 | | | | • | • | • |
| 80 | | | | • | • | |

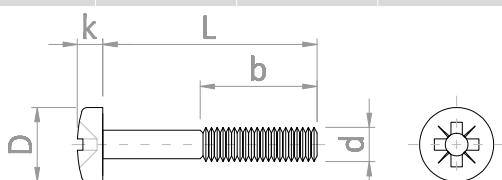
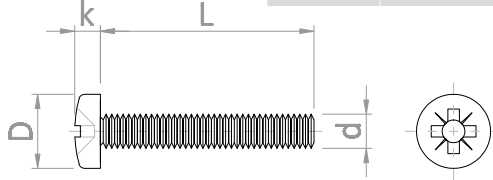

METRIC SCREWS with button head
WKRETY METRYCZNE z łbem podkładkowym



| d | M4 | M6 |
|--------|----------|----------|
| D [mm] | 10 | 14 |
| k [mm] | 2,5 | 3,4 |
| L [mm] | 413A0040 | 413A0060 |
| 8 | • | |
| 9 | • | |
| 10 | • | • |
| 12 | • | • |
| 14 | • | |
| 16 | • | • |
| 20 | • | • |
| 22 | • | • |
| 25 | • | • |
| 28 | • | |
| 30 | • | • |
| 35 | • | • |
| 40 | • | • |
| 45 | | • |
| 50 | • | • |

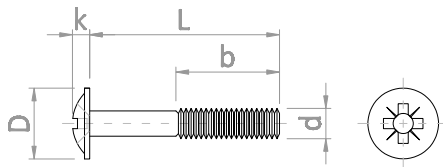
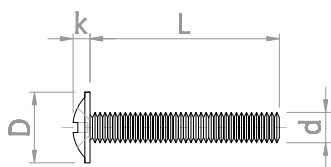

| d | M6 | M8 | M10 |
|---------|----------|----------|----------|
| D [mm] | 11 | 14,5 | 18 |
| PZ [mm] | 3 | 4 | 4 |
| L [mm] | 421A0060 | 421A0080 | 421A0100 |
| 10 | • | | |
| 12 | • | | |
| 16 | • | • | |
| 20 | • | • | • |
| 25 | • | • | • |
| 30 | • | • | • |
| 35 | • | • | • |
| 40 | • | • | • |
| 45 | • | | • |
| 50 | • | • | • |
| 60 | • | | • |

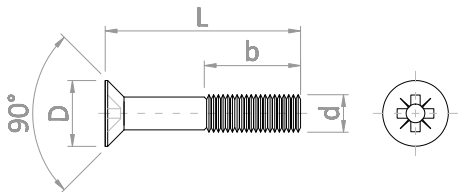
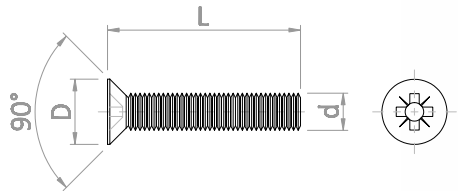

WKRETY DO METALU

METRIC SCREWS flat head, hex drive
WKRETY METRYCZNE z łbem stożkowym, nacięcie imbusowe

| d | M5 | M6 | M8 | M10 |
|--------|----------|----------|----------|----------|
| D [mm] | 10 | 11,8 | 16 | 30 |
| s [mm] | 3 | 4 | 5 | 6 |
| L [mm] | 426A0050 | 426A0060 | 426A0080 | 426A0100 |
| 12 | • | • | | |
| 14 | • | • | | |
| 16 | • | • | • | • |
| 18 | • | • | • | |
| 20 | • | • | • | • |
| 25 | • | • | • | • |
| 30 | • | • | • | • |
| 35 | • | • | • | • |
| 40 | • | • | • | • |
| 45 | • | • | • | • |
| 50 | • | • | • | • |
| 55 | • | • | • | • |
| 60 | • | • | • | • |
| 65 | | • | • | • |
| 70 | | • | • | • |
| 80 | | • | • | |

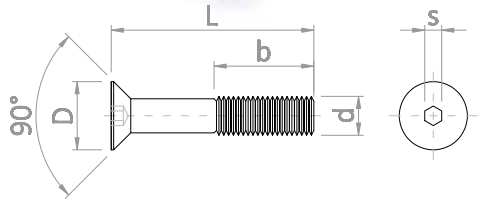
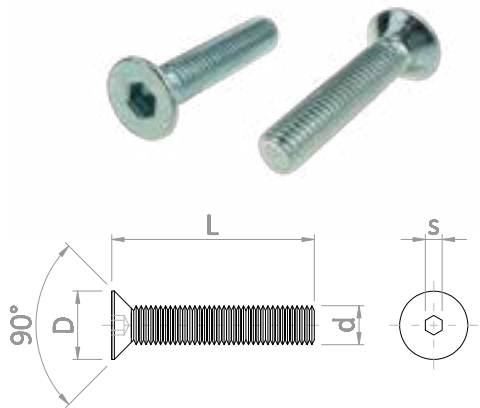

METRIC SCREWS with flat head, hex drive
WKRETY METRYCZNE z łbem walcowym i nacięciem imbusowym

METRIC SCREWS with flat head, hex drive and pilot
WKRETY METRYCZNE z łbem walcowym, nacięciem imbusowym i wprowadzeniem

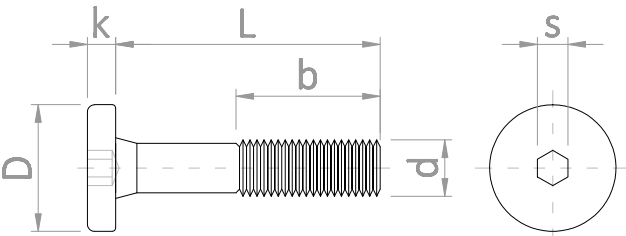
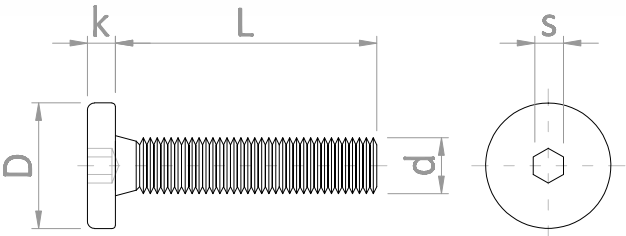

| d | M6 | M8 |
|--------|----------|----------|
| D [mm] | 14,5 | 18 |
| k [mm] | 2,2 | 4 |
| S [mm] | 4 | 5 |
| L [mm] | 562A0060 | 562A0080 |
| 12 | • | |
| 15 | • | |
| 16 | • | • |
| 20 | • | • |
| 25 | • | • |
| 30 | • | • |
| 35 | • | • |
| 40 | • | • |
| 45 | • | • |
| 50 | • | • |
| 55 | • | |
| 60 | • | • |
| 65 | • | |
| 70 | • | • |
| 75 | • | |
| 80 | • | • |
| 85 | • | |
| 90 | • | • |
| 95 | • | |
| 100 | • | • |
| 105 | • | |
| 110 | • | |
| 120 | • | |

Available in other sizes and finishing for customer's order
Dostępne inne wymiary i wykończenie na zamówienie klienta

| d | M6 | M8 |
|--------|---------------|---------------|
| D [mm] | 14,5 | 18 |
| k [mm] | 2,2 | 4 |
| S [mm] | 4 | 5 |
| L [mm] | 562A0060...WP | 562A0080...WP |
| 35 | • | |
| 40 | • | |
| 45 | • | |
| 50 | • | |
| 55 | • | |
| 60 | • | • |
| 65 | • | |
| 70 | • | |
| 80 | • | • |
| 90 | • | |
| 100 | • | |
| 110 | • | |

Available in other sizes and finishing for customer's order
Dostępne inne wymiary i wykończenie na zamówienie klienta

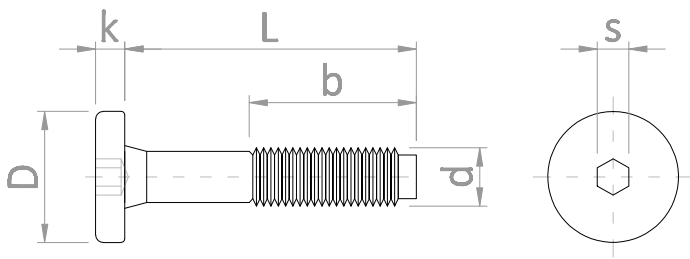

TURNING PARTS for special customer needs
ELEMENTY TOCZONE pod zamówienie klienta

TURNING PARTS for special customer needs
ELEMENTY TOCZONE pod zamówienie klienta

Pod zamówienia klientów wdrażamy indywidualne rozwiązania, które toczymy wg. przekazanych nam rysunków.

Jesteśmy w stanie dostarczyć duże serie produkcyjne na podstawie zamówień ramowych oraz małe partie według jednostkowych zamówień.

Możliwości produkcyjne:

Średnica Ø: 4,5 - 18,5 mm
Skok gwintu: 2,2 - 3 mm
Długość: 5 - 120 mm
Gwint metryczny: M3 - M14

Materiał: Stal, Stal nierdzewna, Mosiądz

Tolerancja: 0,1 - 0,05 mm

Klasa twardości: 4.8

Wykończenie: surowe, ocynk biały, ocynk żółty, nikiel.

On special customer needs we can provide individual solutions. Special parts will be prepared basic on customer technical drawings.

Production capacity:

Diameter Ø: 4,5 - 18,5 mm
Length: 5 - 120 mm
Thread: M3 - M14

Material: steel, stainless steel, brass

Tolerance: 0,1 - 0,05 mm

Hardness: 4.8

Finishing: raw, zinc plated, yellow zinc plated, nickel

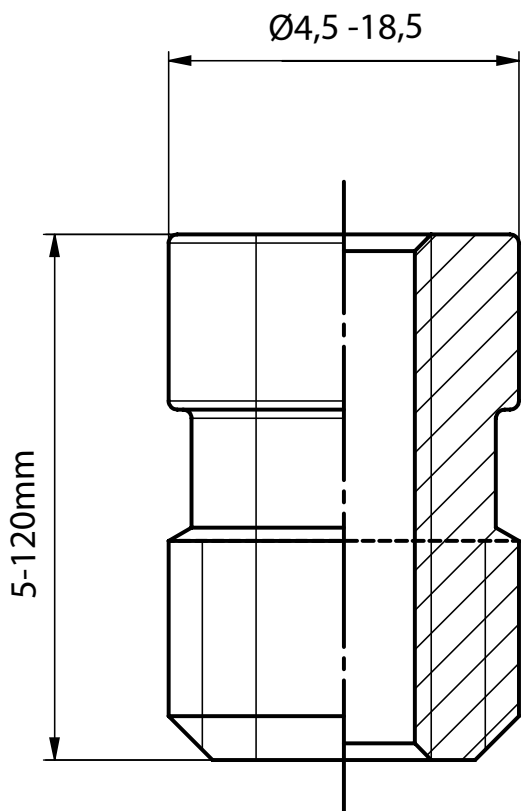

COLD FORGING PARTS for special customer needs
ELEMENTY COLD FORGING pod zamówienie klienta

COLD FORGING PARTS for special customer needs
ELEMENTY COLD FORGING pod zamówienie klienta

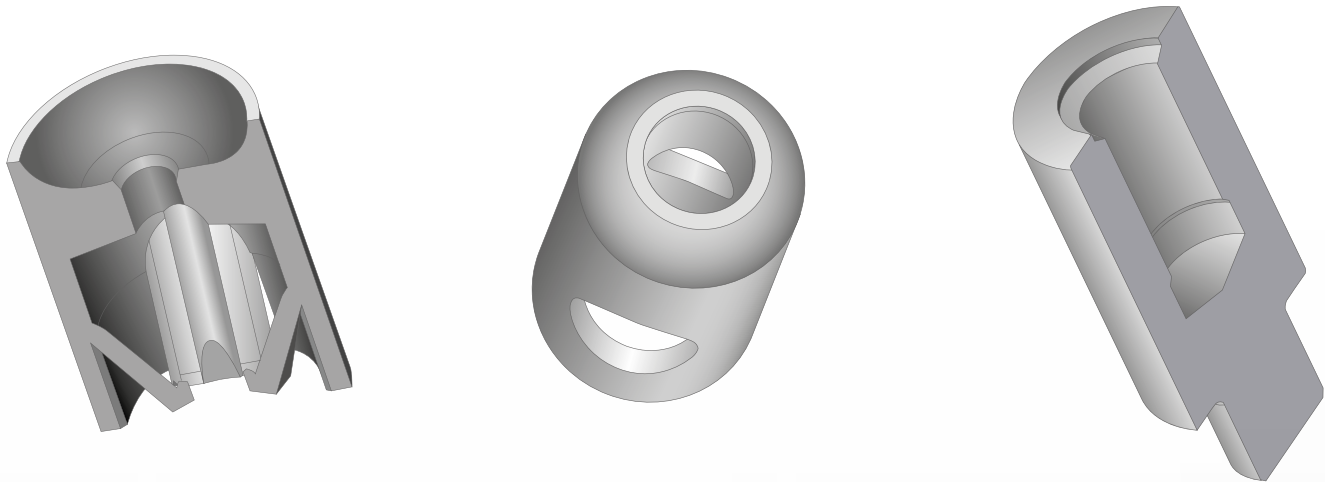

Tworzymy elementy potrzebne bezpośrednio do produkcji dla naszych klientów. Wykonujemy je na podstawie przekazanych nam rysunków detali. Zachęcamy do transferu produktów z technologii wytaczania do technologii cold-forging, aby przyspieszyć czas produkcji oraz zaoszczędzić materiał. Metoda cold-forging dotyczy tylko detali w dużych seriach - oraz specjalnych, gdzie jest duży odpad materiału w porównaniu do elementów toczonech.

Wielkość detali:
Średnica Ø: 4 - 20 mm
Długość: 5 - 100 mm
Gwint metryczny: M4 - M16

Materiał: Stal, Mosiądz

Tolerancja: 0,1 - 0,05 mm

Klasa twardości: 4.8

Wykończenie: surowe, ocynk biały, ocynk żółty, nikiel, mosiądzowane, ocynk czarny, oksydowany, oraz inne specjalne.

On special customer needs we can provide individual solutions. Special parts will be prepared basic on customer technical drawings. We transfer products from turning to cold-forging technology in order to save time and money!

Production capacity:
Diameter Ø: 4 - 20 mm
Length: 5 - 100 mm
Thread: M3 - M16

Material: steel, brass

Tolerance: 0,1 - 0,05 mm

Hardness: 4.8

Finishing: raw, zinc plated, yellow zinc plated, nickel, brass plated, black oxide, black zinc plated and other special finishings.

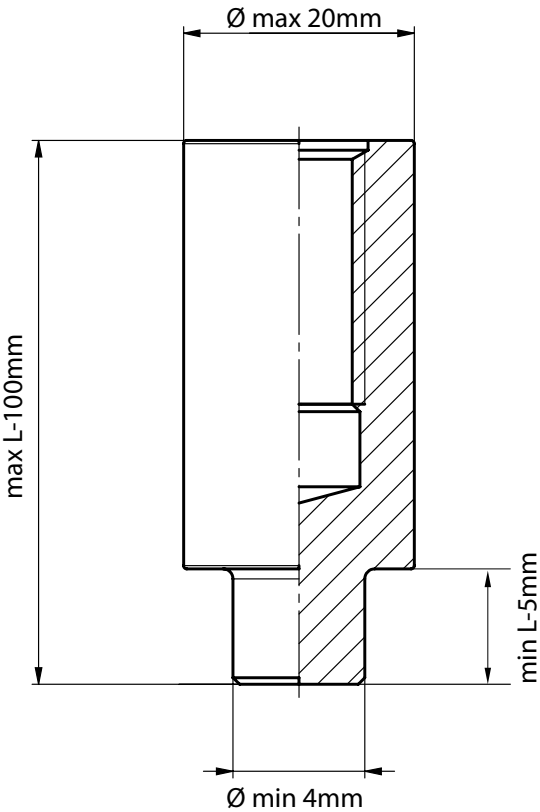

SLEEVE NUTS with flat head, hex drive
NAKRĘTKI ERICSONA z płaskim łbem, nacięciem imbusowym

SLEEVE NUTS with flat head, hex drive
NAKRĘTKI ERICSONA z płaskim łbem, nacięciem imbusowym

| Art. | DK [mm] | d | ds [mm] | s [mm] | k [mm] | b [mm] | l [mm] |
|------------|---------|-----|---------|--------|--------|--------|--------|
| 563C305009 | 15 | M5 | 9 | 4 | 2 | 6 | 9 |
| 563C105015 | 14.5 | M5 | 7 | 5 | 2 | 10 | 15 |
| 608A506009 | 12 | M6 | 7.8 | 4 | 2 | 6 | 9 |
| 563A006010 | 15 | M6 | 9 | 5 | 2 | 5 | 10 |
| 563A006012 | 15 | M6 | 9 | 5 | 2 | 7 | 12 |
| 563A006015 | 15 | M6 | 9 | 5 | 2 | 10 | 15 |
| 563A006018 | 15 | M6 | 9 | 5 | 2 | 13 | 18 |
| 563A006022 | 15 | M6 | 9 | 5 | 2 | 14 | 22 |
| 563A006025 | 15 | M6 | 9 | 5 | 2 | 17 | 25 |
| 563C306010 | 15 | M6 | 9 | 4 | 2 | 5 | 10 |
| 563C306012 | 15 | M6 | 9 | 4 | 2 | 7 | 12 |
| 563C306015 | 15 | M6 | 9 | 4 | 2 | 10 | 15 |
| 563C306018 | 15 | M6 | 9 | 4 | 2 | 13 | 18 |
| 608A006012 | 15 | M6 | 8 | 4 | 2 | 7 | 12 |
| 608A006015 | 15 | M6 | 8 | 4 | 2 | 10 | 15 |
| 608A006022 | 15 | M6 | 8 | 4 | 2 | 12 | 22 |
| 594A00811M | 17 | M8 | 10 | 5 | 2 | 7 | 11,5 |
| 594A008016 | 19 | M8 | 10 | 5 | 2,5 | 11 | 16 |
| 602A610018 | 22,5 | M10 | 13 | 6 | 2 | 12 | 18 |

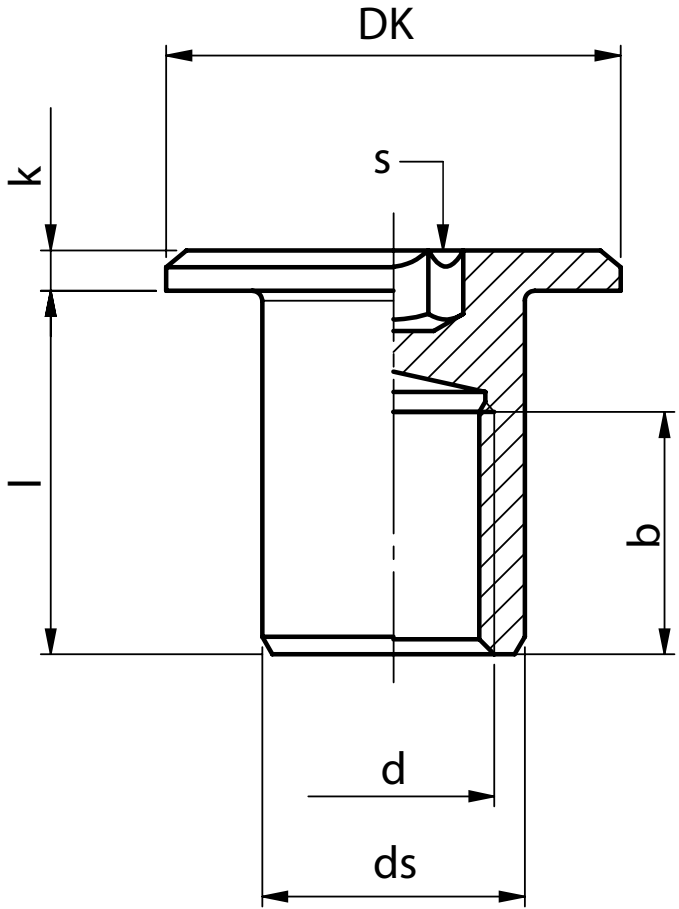

SLEEVE NUTS with round head, hex drive
NAKRĘTKI ERICSONA z łbem wypukłym, nacięciem imbusowym

SLEEVE NUTS with round head, hex drive
NAKRĘTKI ERICSONA z łbem wypukłym, nacięciem imbusowym

| Art. | DK [mm] | d | ds [mm] | s [mm] | k [mm] | b [mm] | l [mm] |
|------------|---------|-----|---------|--------|--------|--------|--------|
| 629A006010 | 13 | M6 | 8 | 5 | 3 | 6 | 10 |
| 564A006010 | 15 | M6 | 9 | 5 | 3 | 5 | 10 |
| 564A006012 | 15 | M6 | 9 | 5 | 3 | 7 | 12 |
| 564A006015 | 15 | M6 | 9 | 5 | 3 | 10 | 15 |
| 564A006018 | 15 | M6 | 9 | 5 | 3 | 13 | 18 |
| 564A006052 | 15 | M6 | 9 | 5 | 3 | 22 | 52 |
| 564C306012 | 15 | M6 | 9 | 4 | 3 | 7 | 12 |
| 564C306015 | 15 | M6 | 9 | 4 | 3 | 10 | 15 |
| 564C306018 | 15 | M6 | 9 | 4 | 3 | 13 | 18 |
| 628A006012 | 15 | M6 | 8 | 4 | 3 | 7,5 | 12 |
| 595A008014 | 20 | M8 | 10 | 5 | 3 | 9,5 | 14 |
| 595A008016 | 20 | M8 | 10 | 5 | 3 | 12 | 16 |
| 595A008020 | 20 | M8 | 10 | 5 | 3 | 15 | 20 |
| 602A010013 | 20 | M10 | 13 | 5 | 4 | 9 | 13 |
| 662A010016 | 30 | M10 | 14 | 6 | 4 | 11,5 | 16 |

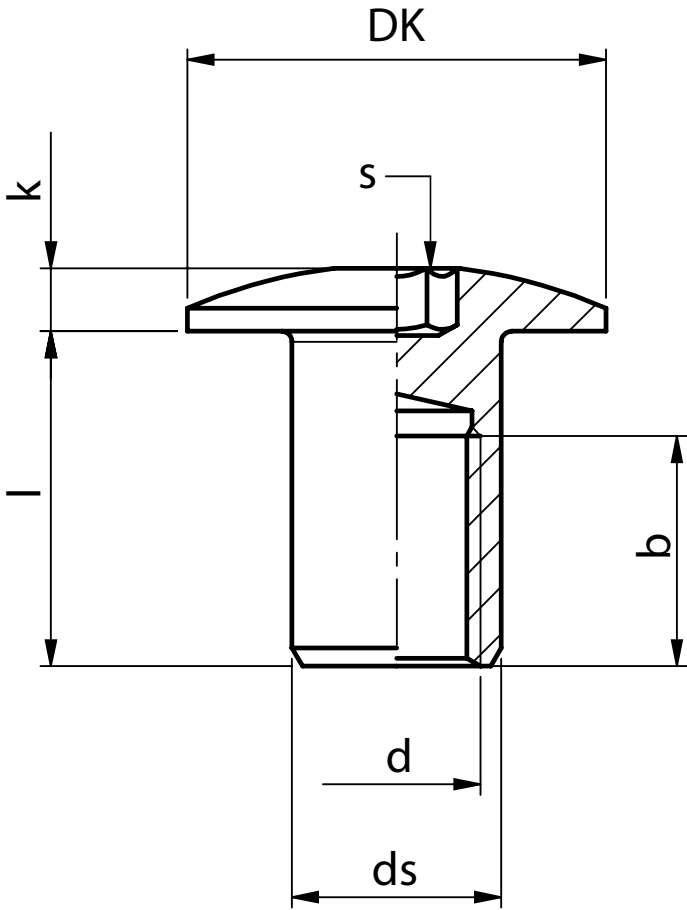

SLEEVE NUTS different models
NAKRĘTKI ERICSONA specjalne modele

SLEEVE NUTS no recess
NAKRĘTKI ERICSONA bez nacięcia

| Art. | DK [mm] | d | ds [mm] | PZD | b [mm] | l [mm] |
|------------|---------|----|---------|-----|--------|--------|
| 641A006015 | 12 | M6 | 7,8 | 2 | 10 | 15 |



| Art. | DK [mm] | d | ds [mm] | k [mm] | b [mm] | l [mm] |
|------------|---------|----|---------|--------|--------|--------|
| 615A008014 | 20 | M8 | 10 | 3 | 10,5 | 14 |

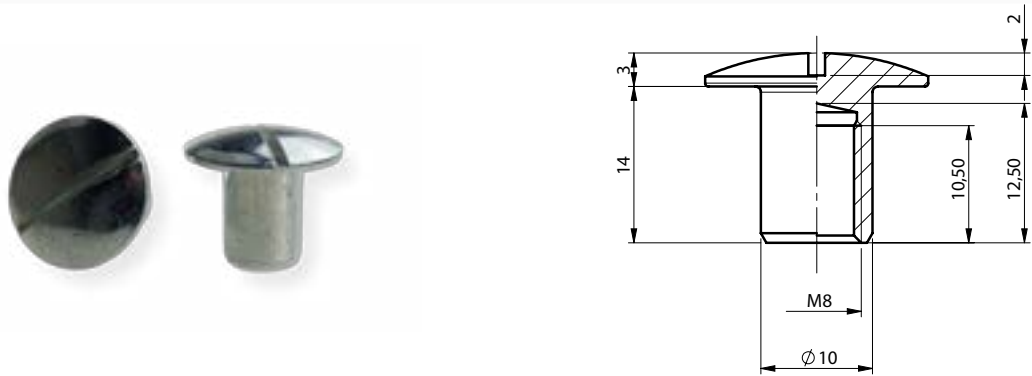

| Art. | DK [mm] | d | ds [mm] | k [mm] | b [mm] | l [mm] |
|------------|---------|----|---------|--------|--------|--------|
| 607C506015 | 16 | M6 | 8 | 3 | 13 | 15 |



| Art. | DK [mm] | d | ds [mm] | k [mm] | b [mm] | l [mm] |
|------------|---------|----|---------|--------|--------|--------|
| 983A006010 | 14 | M6 | 9 | 2,6 | 5 | 10 |



| Art. | DK [mm] | d | ds [mm] | k [mm] | b [mm] | l [mm] |
|------------|---------|----|---------|--------|--------|--------|
| 607A004008 | 9 | M4 | 6 | 1,5 | 6 | 8 |
| 607A004010 | 9 | M4 | 6 | 1,5 | 8 | 10 |
| 607A006010 | 15 | M6 | 8 | 3,5 | 7,5 | 10 |

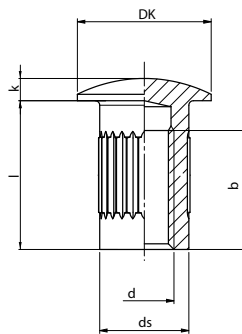

| Art. | DK [mm] | d | ds [mm] | k [mm] | b [mm] | l [mm] |
|------------|---------|----|---------|--------|--------|--------|
| 636A60408M | 10 | M4 | 5 | 1 | 5,8 | 8,5 |

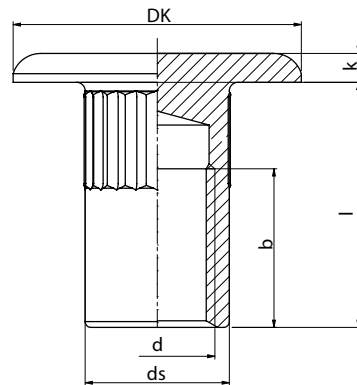

| Art. | DK [mm] | d | ds [mm] | k [mm] | b [mm] | l [mm] |
|------------|---------|----|---------|--------|--------|--------|
| 674A006008 | 13 | M6 | 9,3 | 1,5 | 5 | 8 |
| 674A006010 | 13 | M6 | 9,3 | 1,5 | 7 | 10 |

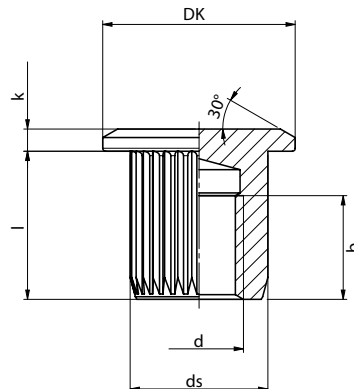

SCREW IN INSERTS with collar
MUFY WKREĆCANE z kołnierzem

SCREW IN INSERTS without collar
MUFY WKREĆCANE bez kołnierza

| Art. | DK [mm] | d | diam [mm] | s [mm] | k [mm] | l [mm] |
|------------|---------|----|-----------|--------|--------|--------|
| 314A004010 | 8 | M4 | 8 | 4 | 1,5 | 10 |
| 314A005012 | 9 | M5 | 9 | 5 | 1,5 | 12 |
| 314A006012 | 12 | M6 | 12 | 6 | 1 | 12 |
| 314A006015 | 12 | M6 | 12 | 6 | 1 | 15 |
| 314A006018 | 12 | M6 | 12 | 6 | 1 | 18 |
| 314A008015 | 14 | M8 | 14 | 8 | 1 | 15 |

| Art. | d | Ø [mm] | l [mm] |
|--------|-----|--------|--------|
| 13.101 | M4 | 6,5 | 8 |
| 13.102 | M4 | 8 | 8 |
| 13.104 | M4 | 8 | 10 |
| 13.115 | M6 | 10 | 7 |
| 13.105 | M6 | 10 | 8 |
| 13.116 | M6 | 10 | 10 |
| 13.103 | M6 | 10 | 12 |
| 13.107 | M6 | 12 | 12 |
| 13.108 | M6 | 12 | 15 |
| 13.109 | M6 | 12 | 18 |
| 13.106 | M8 | 12 | 15 |
| 13.110 | M8 | 12 | 18 |
| 13.111 | M8 | 12 | 25 |
| 13.112 | M10 | 16 | 17 |
| 13.113 | M10 | 18,5 | 25 |

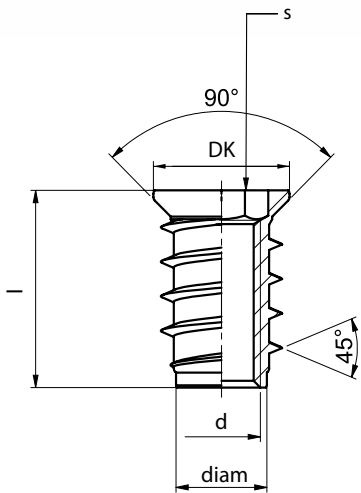
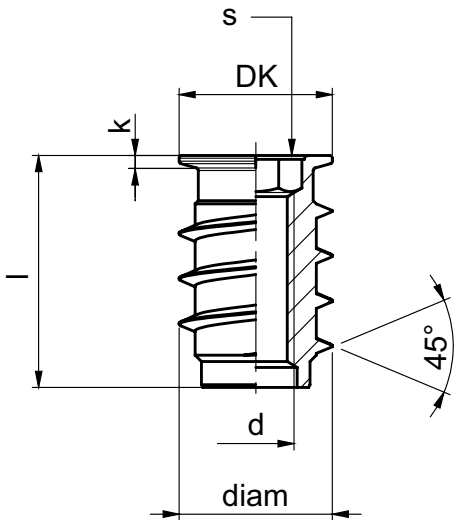
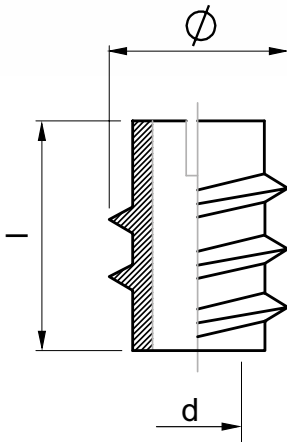

| Art. | DK [mm] | d | diam [mm] | s [mm] | l [mm] |
|------------|---------|-----|-----------|--------|--------|
| 312A006012 | 12 | M6 | 10 | 6 | 12 |
| 312A006013 | 12 | M6 | 10 | 6 | 13 |
| 312A006014 | 12 | M6 | 10 | 6 | 14 |
| 312A006015 | 12 | M6 | 10 | 6 | 15 |
| 312A006017 | 12 | M6 | 10 | 6 | 17 |
| 312A006020 | 12 | M6 | 10 | 6 | 20 |
| 312A006024 | 12 | M6 | 10 | 6 | 24 |
| 312A008013 | 14 | M8 | 12,5 | 8 | 13 |
| 312A008015 | 14 | M8 | 12,5 | 8 | 15 |
| 312A008017 | 14 | M8 | 12,5 | 8 | 17 |
| 312A008020 | 14 | M8 | 12,5 | 8 | 20 |
| 312A008022 | 14 | M8 | 12,5 | 8 | 22 |
| 312A008024 | 14 | M8 | 12,5 | 8 | 24 |
| 312A008028 | 14 | M8 | 12,5 | 8 | 28 |
| 312A010017 | 17 | M10 | 15,3 | 10 | 17 |
| 312A010020 | 17 | M10 | 15,3 | 10 | 20 |
| 312A010025 | 17 | M10 | 15,3 | 10 | 25 |

| Art. | d | Ø [mm] | s [mm] | l [mm] |
|--------|-----|--------|--------|--------|
| 13.221 | M6 | 12 | 6 | 12 |
| 13.222 | M6 | 12 | 6 | 15 |
| 13.220 | M6 | 12 | 6 | 18 |
| 13.200 | M8 | 14 | 8 | 25 |
| 13.201 | M8 | 15 | 8 | 25 |
| 13.205 | M10 | 18,5 | 10 | 40 |

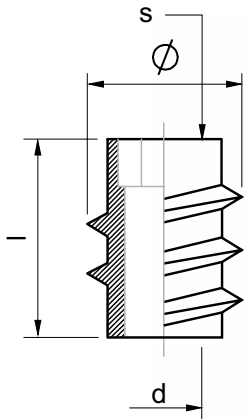

| Art. | d | diam [mm] | s [mm] | l [mm] |
|------------|-----|-----------|--------|--------|
| 319A008020 | M8 | 18,5 | 8 | 20 |
| 319A008025 | M8 | 18,5 | 8 | 25 |
| 319A010020 | M10 | 18,5 | 10 | 20 |
| 319A010025 | M10 | 18,5 | 10 | 25 |
| 319A012025 | M12 | 18,5 | 12 | 25 |

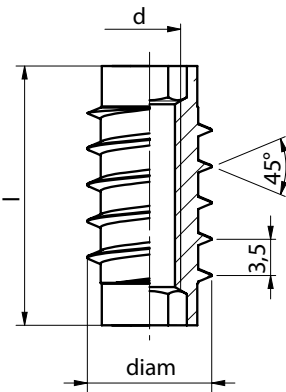

SCREW IN INSERTS with collar
MUFY WKREĆANE z kołnierzem

SCREW IN INSERTS with collar
MUFY WKREĆANE z kołnierzem

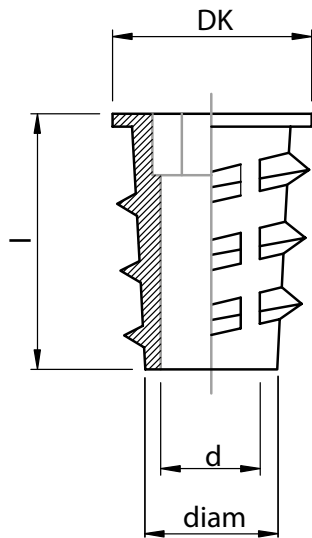
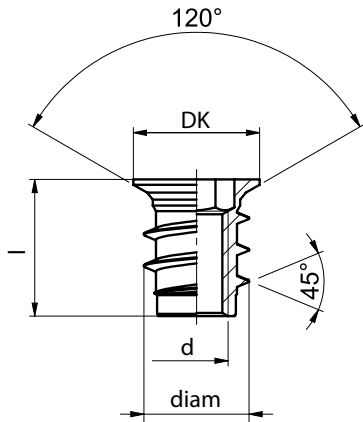

| Art. | DK [mm] | d | diam [mm] | s [mm] | l [mm] |
|--------|---------|-----|-----------|--------|--------|
| 13.001 | 12 | M6 | 10 | 6 | 10 |
| 13.002 | 12 | M6 | 10 | 6 | 13 |
| 13.003 | 12 | M6 | 10 | 6 | 15 |
| 13.004 | 12 | M6 | 10 | 6 | 17 |
| 13.010 | 12 | M6 | 10 | 6 | 20 |
| 13.005 | 14 | M8 | 12 | 8 | 15 |
| 13.006 | 14 | M8 | 12 | 8 | 20 |
| 13.007 | 14 | M8 | 12 | 8 | 22 |
| 13.008 | 14 | M8 | 12 | 8 | 24 |
| 13.009 | 16 | M10 | 15 | 10 | 18 |

| Art. | DK [mm] | d | diam [mm] | s [mm] | l [mm] |
|--------|---------|-----|-----------|--------|--------|
| 13.250 | 8,5 | M4 | 5,5 | 4 | 10 |
| 13.251 | 11,5 | M5 | 7 | 5 | 10 |
| 13.240 | 12 | M6 | 7 | 6 | 10 |
| 13.241 | 12 | M6 | 7 | 6 | 13 |
| 13.242 | 12 | M6 | 7 | 6 | 15 |
| 13.243 | 12 | M6 | 7 | 6 | 18 |
| 13.244 | 12 | M6 | 7 | 6 | 20 |
| 13.245 | 12 | M6 | 7 | 6 | 25 |
| 13.246 | 14 | M8 | 9 | 8 | 13 |
| 13.247 | 14 | M8 | 9 | 8 | 15 |
| 13.248 | 14 | M8 | 9 | 8 | 20 |
| 13.249 | 14 | M8 | 9 | 8 | 25 |
| 13.252 | 16 | M10 | 11 | 10 | 13 |
| 13.254 | 16 | M10 | 11 | 10 | 20 |
| 13.253 | 16 | M10 | 11 | 10 | 25 |

| Art. | DK [mm] | d | diam [mm] | s [mm] | l [mm] |
|------------|---------|-----|-----------|--------|--------|
| 318A008020 | 18,5 | M8 | 18,5 | 8 | 20 |
| 318A008025 | 18,5 | M8 | 18,5 | 8 | 25 |
| 318A010020 | 18,5 | M10 | 18,5 | 10 | 20 |
| 318A010025 | 18,5 | M10 | 18,5 | 10 | 25 |

| Art. | DK [mm] | d | diam [mm] | s [mm] | l [mm] |
|------------|---------|----|-----------|--------|--------|
| 317A004008 | 12 | M4 | 10 | 6 | 8 |
| 317A004010 | 12 | M4 | 10 | 6 | 10 |
| 317A006008 | 12 | M6 | 10 | 6 | 8 |
| 317A006010 | 12 | M6 | 10 | 6 | 10 |

| Art. | DK [mm] | d | diam [mm] | s [mm] | l [mm] |
|------------|---------|----|-----------|--------|--------|
| 312N106012 | 9,8 | M6 | 10 | 6 | 12 |

| Art. | DK [mm] | d | diam [mm] | s [mm] | l [mm] |
|------------|---------|----|-----------|--------|--------|
| 312C106013 | 12 | M6 | 10 | 6 | 13 |

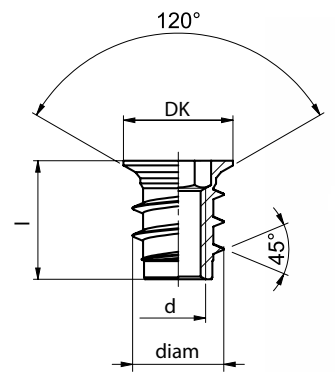
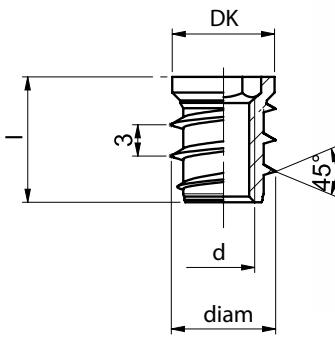
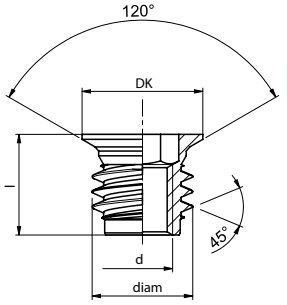
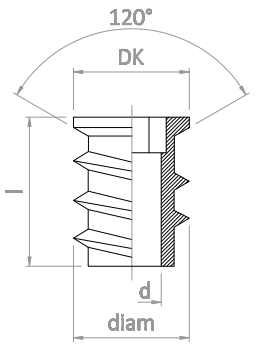

SCREW IN INSERTS without collar
MUFY WKREĆCANE bez kotnierza

SCREW IN INSERTS special
MUFY WKREĆCANE specjalne

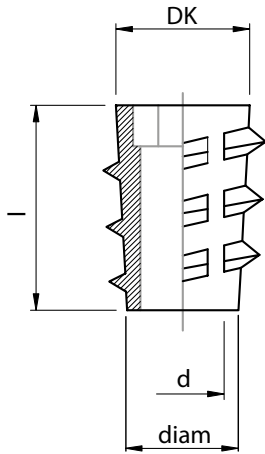

| Art. | DK [mm] | d | diam [mm] | s [mm] | l [mm] |
|--------|---------|----|-----------|--------|--------|
| 13.230 | 9 | M6 | 7 | 6 | 10 |
| 13.231 | 9 | M6 | 7 | 6 | 13 |
| 13.232 | 9 | M6 | 7 | 6 | 15 |
| 13.233 | 9 | M6 | 7 | 6 | 18 |
| 13.234 | 9 | M6 | 7 | 6 | 20 |
| 13.235 | 11 | M8 | 9 | 8 | 13 |
| 13.236 | 11 | M8 | 9 | 8 | 15 |
| 13.237 | 11 | M8 | 9 | 8 | 18 |
| 13.238 | 11 | M8 | 9 | 8 | 20 |

| Art. | DK [mm] | d | diam [mm] | l [mm] |
|--------|---------|----|-----------|--------|
| 13.280 | 16 | M5 | 14 | 7 |
| 13.281 | 16 | M6 | 14 | 7 |

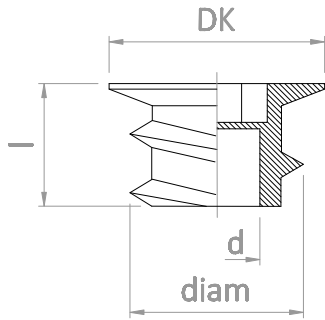

SCREW IN INSERTS blind
MUFY WKREĆCANE zaślepione

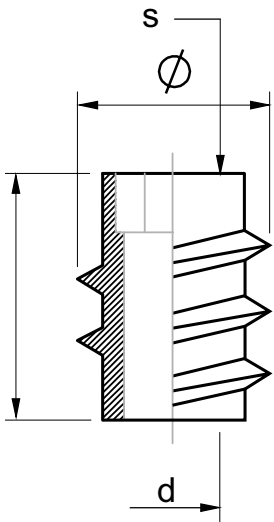

| Art. | d | Ø [mm] | s [mm] | l [mm] |
|--------|----|--------|--------|--------|
| 13.206 | M8 | 15 | 8 | 30 |
| 13.207 | M8 | 15 | 8 | 39 |

| Art. | DK [mm] | d | diam [mm] | s [mm] | k [mm] | l [mm] |
|------------|---------|----|-----------|--------|--------|--------|
| 318L206016 | 15 | M6 | 10 SX | 6 | 2 | 16 |

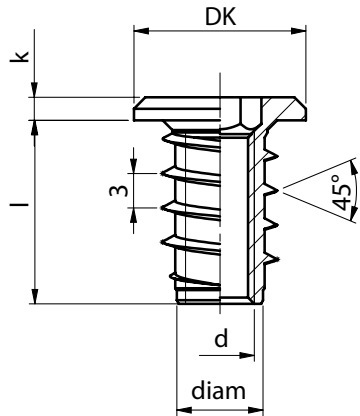

| Art. | DK [mm] | d | diam [mm] | s [mm] | k [mm] | l [mm] |
|------------|---------|-----|-----------|--------|--------|--------|
| 318F508017 | 22 | M8 | 15,3 SX | 10 | 2,5 | 17 |
| 318F510015 | 22 | M10 | 15,3 SX | 10 | 2,5 | 15 |
| 318F510017 | 22 | M10 | 15,3 SX | 10 | 2,5 | 17 |

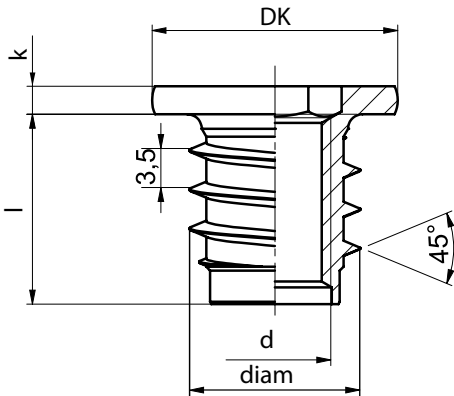

| Art. | DK [mm] | d | diam [mm] | s [mm] | l [mm] |
|------------|---------|-----|-----------|--------|--------|
| 318C008020 | 18,5 | M8 | 18,5 | 8 | 20 |
| 318C010C20 | 18,5 | M10 | 18,5 | 10 | 20 |
| 318C010C25 | 18,5 | M10 | 18,5 | 10 | 25 |



KNOCK DOWN INSERTS with collar
MUFY WBIJANE z kołnierzem

KNOCK DOWN INSERTS
MUFY WBIJANE

| Art. | DK | d | diam [mm] | ds [mm] | k [mm] | l [mm] |
|------------|----|-----|-----------|---------|--------|--------|
| 645A00506M | 11 | M5 | 7,5 | 7,5 | 1 | 6,5 |
| 645A006014 | 14 | M6 | 9 | 8,3 | 1,5 | 14 |
| 645A008016 | 19 | M8 | 11 | 10,4 | 2,5 | 16 |
| 645A010017 | 22 | M10 | 13 | 12,4 | 2,5 | 17 |

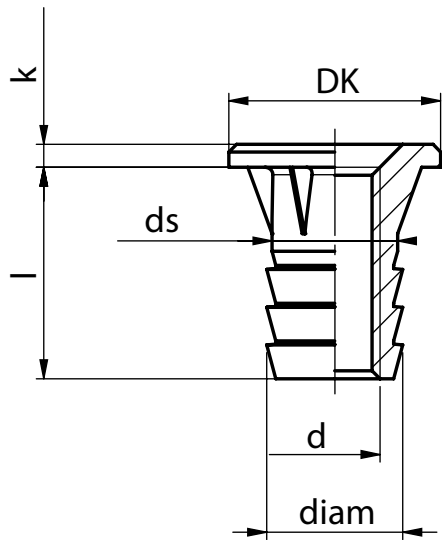

| Art. | DK | d | ds [mm] | k [mm] | l [mm] |
|------------|----|-----|---------|--------|--------|
| 670A006009 | 15 | M6 | 8,5 | 2 | 9 |
| 670A006014 | 15 | M6 | 8,5 | 2 | 14 |
| 670A008016 | 19 | M8 | 10,8 | 2 | 16 |
| 670A010015 | 22 | M10 | 12,6 | 2,5 | 15 |

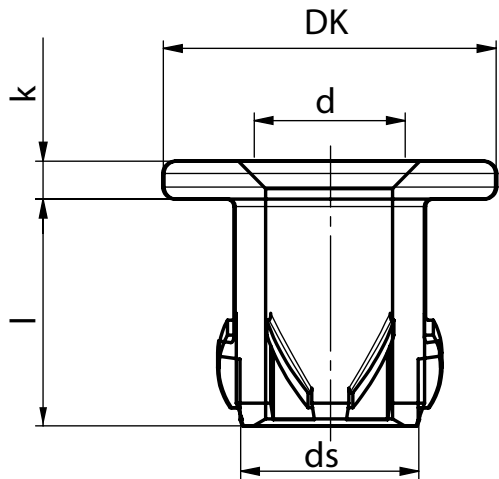

| Art. | d | ds [mm] | l [mm] |
|--------|----|---------|--------|
| 13.430 | M4 | 5,5 | 10 |
| 13.431 | M6 | 7,5 | 10 |

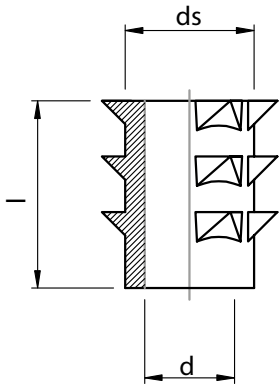

| Art. | DK | d | ds [mm] | l [mm] |
|--------|----|----|---------|--------|
| 13.432 | 12 | M6 | 7,5 | 11 |

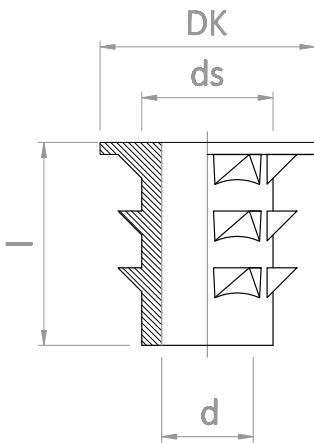

| Art. | d | diam [mm] | Ø [mm] | k [mm] | l [mm] |
|--------|-----|-----------|--------|--------|--------|
| 13.508 | M3 | 4,5 | 13 | 0,8 | 5 |
| 13.507 | M4 | 5,2 | 15 | 0,8 | 8 |
| 13.506 | M5 | 6,2 | 18 | 1,0 | 8 |
| 13.500 | M6 | 7,3 | 19 | 1,2 | 9 |
| 13.501 | M6 | 7,3 | 19 | 1,2 | 12 |
| 13.504 | M6 | 7,3 | 19 | 1,2 | 15 |
| 13.502 | M8 | 9,1 | 22 | 1,2 | 11 |
| 13.505 | M8 | 9,6 | 22 | 1,4 | 15 |
| 13.503 | M10 | 12 | 25 | 1,4 | 13 |

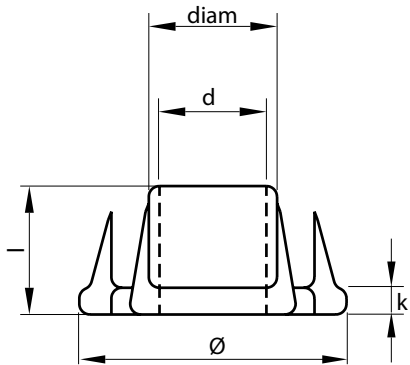

BRASS INSERTS for handles
MUFY MOSIĘŻNE rozporowe

KNOCK DOWN INSERTS
MUFY WBIJANE



| Art. | b | Ø [mm] | l [mm] |
|--------|----|--------|--------|
| 13.402 | M4 | 5,2 | 8 |
| 13.403 | M4 | 5,2 | 10 |

| Art. | Ø [mm] | l [mm] |
|--------|--------|--------|
| 13.309 | 5 | 8 |
| 13.305 | 5 | 10 |
| 13.310 | 5 | 12 |

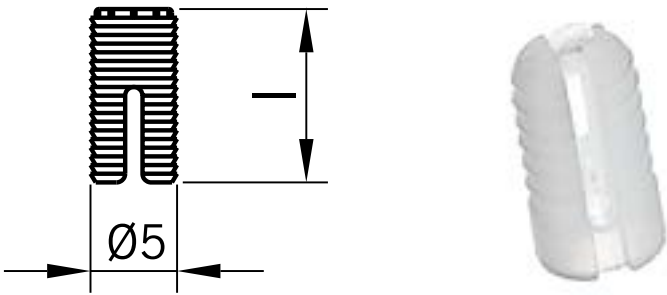

BRASS INSERTS with expansion ball
MUFY MOSIĘŻNE z kulką rozporową



| Art. | d | e [mm] | l [mm] |
|--------|----|--------|--------|
| 13.409 | M4 | 5,5 | 10 |
| 13.407 | M6 | 8 | 9 |
| 13.401 | M6 | 8 | 12 |
| 13.404 | M6 | 8 | 15 |

| Art. | d | Ø [mm] | l [mm] |
|--------|----|--------|--------|
| 13.308 | M6 | 8,5 | 10 |

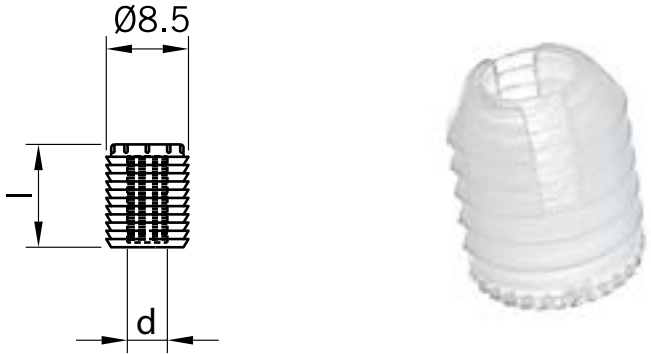

BRASS INSERTS without expansion ball
MUFY MOSIĘŻNE bez kulki rozporowej



| Art. | d | e [mm] | l [mm] |
|--------|----|--------|--------|
| 13.410 | M4 | 5,5 | 7,5 |
| 13.408 | M4 | 5,5 | 10 |
| 13.406 | M6 | 8 | 9 |
| 13.405 | M6 | 8 | 12 |

| Art. | d | Ø [mm] | l [mm] |
|--------|----|--------|--------|
| 13.312 | M4 | 8 | 8 |
| 13.311 | M4 | 8 | 10 |
| 13.301 | M6 | 11 | 11 |
| 13.307 | M6 | 11 | 13 |

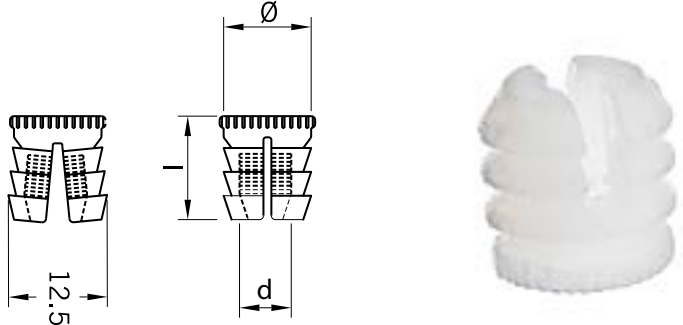

BRASS INSERTS for special application
TULEJA MOSIĘŻNA rozporowa



| Art. | d | l [mm] |
|--------|-----|--------|
| 13.419 | M4 | 16 |
| 13.420 | M6 | 25 |
| 13.421 | M8 | 28 |
| 13.422 | M10 | 33 |
| 13.423 | M12 | 38 |

| Art. | d | Ø [mm] | l [mm] |
|--------|----|--------|--------|
| 13.303 | M6 | 11 | 11 |
| 13.304 | M6 | 11 | 13 |



| Art. | d | Ø [mm] | l [mm] |
|--------|----|--------|--------|
| 13.302 | M6 | 8 | 12 |

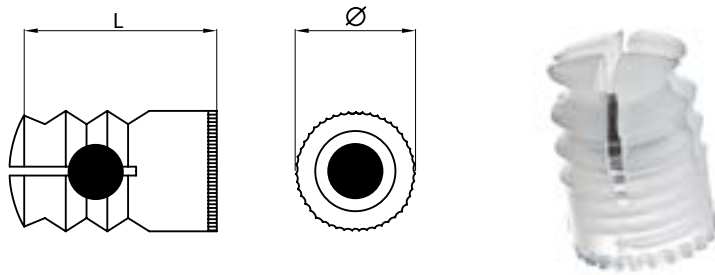

EXCENTERS CONNECTORS
MIMOŚRODY

ROLLER DOWELS euro thread
ZACZEPY ROLLER gwint euro

SCHEMAT WIERCEŃ | DRILLING DIAGRAM

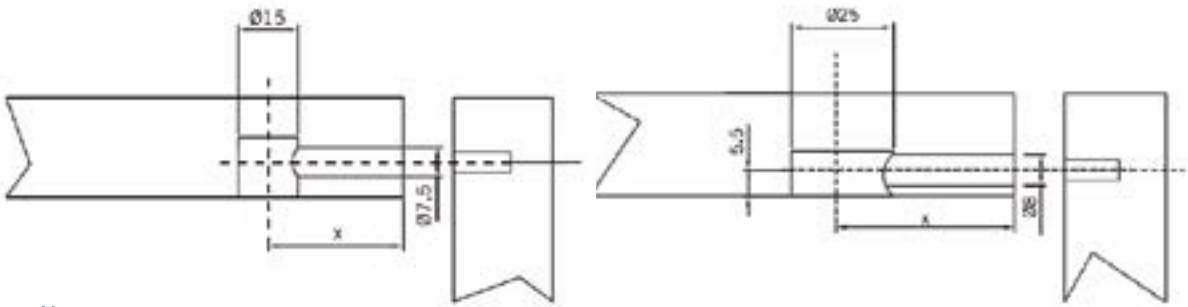

x – długość zaczepu

| Art. | b | l [mm] | x [mm] | n [mm] |
|--------|------|--------|--------|--------|
| GS1031 | EURO | 45 | 34 | 11 |
| GS1032 | EURO | 39 | 28 | 11 |
| GS1033 | EURO | 35 | 24 | 11 |
| GS1034 | EURO | 43 | 34 | 8 |

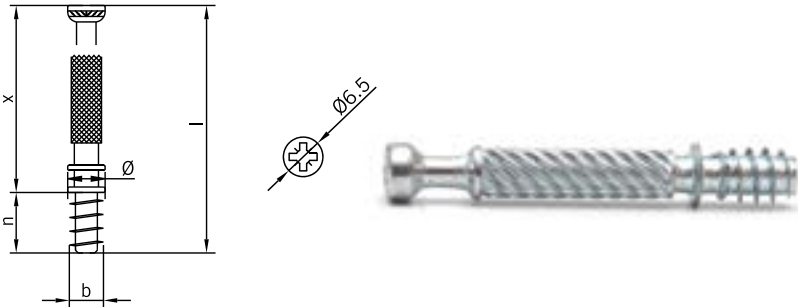

EXCENTERS Ø 15 MM
MIMOŚRODY Ø 15 MM

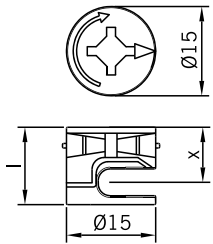

| Art. | | l [mm] | x [mm] |
|--------|-------|--------|--------|
| 11.000 | 12 | 10,4 | 6 |
| 11.001 | 15-16 | 12 | 7,5 |
| 11.002 | 18 | 13,8 | 8 |
| 11.004 | 19 | 13,2 | 9,2 |
| 11.005 | 22-23 | 16,3 | 11,5 |

| Art. | b | l [mm] | x [mm] | n [mm] |
|--------|----|--------|--------|--------|
| GM1019 | M6 | 43 | 34 | 8 |
| GM1020 | M6 | 37 | 28 | 8 |
| GM1021 | M6 | 33 | 24 | 8 |

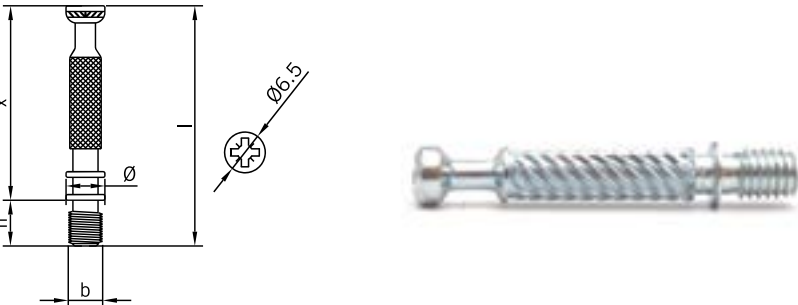

ROLLER DOWELS metric thread
ZACZEPY ROLLER gwint metryczny

EXCENTERS Ø 15 MM strong
MIMOŚRODY Ø 15 MM wzmocnione

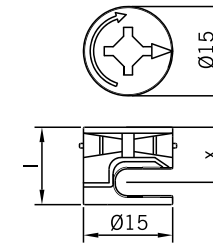

| Art. | | l [mm] | x [mm] |
|----------|-------|--------|--------|
| 11.000.1 | 15-16 | 12 | 7,5 |

| Art. | b | l [mm] | x [mm] | n [mm] |
|--------|------|--------|--------|--------|
| TPK001 | EURO | 45 | 34 | 11 |
| TPK002 | EURO | 39 | 28 | 11 |
| TPK003 | EURO | 35 | 24 | 11 |



TPK DOWELS euro thread
ZACZEPY TPK gwint euro

| Art. | b | l [mm] | x [mm] | n [mm] |
|-------|------|--------|--------|--------|
| TD001 | EURO | 45 | 34 | 11 |

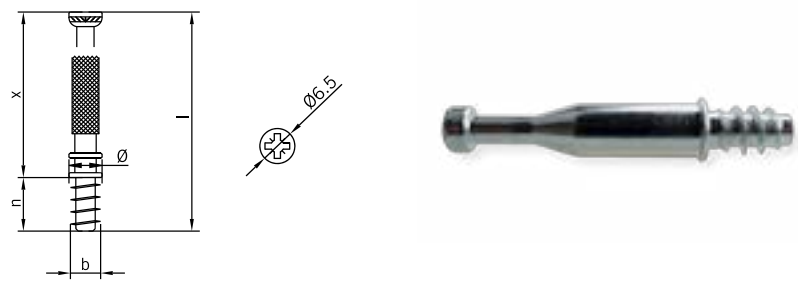

TD DOWELS euro thread
ZACZEPY TD gwint euro

EXCENTERS Ø 25 MM
MIMOŚRODY Ø 25 MM

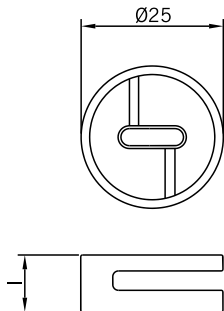

| Art. | | l [mm] |
|--------|----|--------|
| 11.003 | 16 | 11,7 |

| Art. | b | l [mm] | x [mm] | n [mm] |
|-------|------|--------|--------|--------|
| SK001 | EURO | 45 | 34 | 11 |
| SK002 | EURO | 39 | 28 | 11 |
| SK003 | EURO | 35 | 24 | 11 |



SK DOWELS euro thread
ZACZEPY SK gwint euro

EXPANDING DOWELS quick
ZACZEPY ROZPOROWE

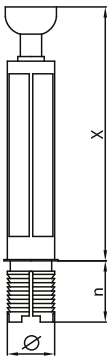

| Art. | Ø [mm] | n [mm] | x [mm] |
|--------|--------|--------|--------|
| 11.050 | 8 | 11 | 34 |
| 11.051 | 8 | 11 | 28 |
| 11.052 | 8 | 11 | 24 |
| 11.053 | 8 | 11 | 21 |

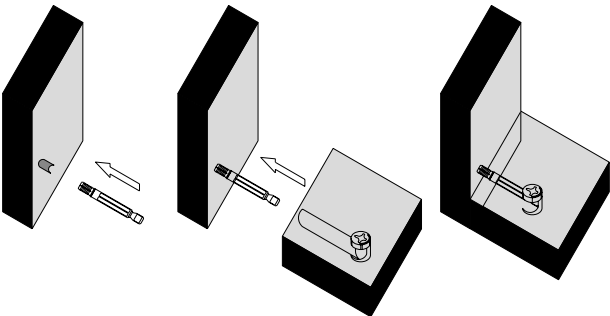

DOUBLE DOWELS with stop O ring
ZACZEPY PODWÓJNE z zabezpieczeniem

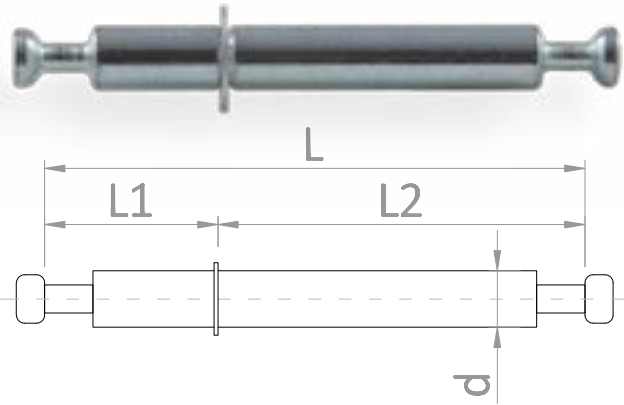

| Art. | d [mm] | L [mm] | L1 [mm] | L2 [mm] |
|-----------|--------|--------|---------|---------|
| 11.070.40 | 7 | 40 | 20 | 20 |
| 11.070.48 | 7 | 48 | 24 | 24 |
| 11.070.56 | 7 | 56 | 20 | 36 |
| 11.070.59 | 7 | 59 | 20 | 39 |
| 11.070.60 | 7 | 60 | 30 | 30 |
| 11.070.62 | 7 | 62 | 23 | 39 |
| 11.070.64 | 7 | 64 | 24 | 40 |
| 11.070.67 | 7 | 67 | 24 | 43 |
| 11.070.76 | 7 | 76 | 30 | 46 |
| 11.070.79 | 7 | 79 | 30 | 49 |

DOUBLE DOWELS without stop O ring
ZACZEPY PODWÓJNE bez zabezpieczenia

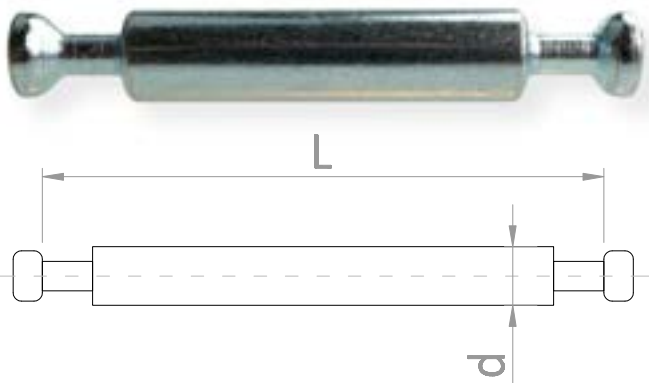

| Art. | d [mm] | L [mm] |
|-----------|--------|--------|
| 11.064.40 | 7 | 40 |
| 11.064.48 | 7 | 48 |
| 11.064.56 | 7 | 56 |
| 11.064.59 | 7 | 59 |
| 11.064.60 | 7 | 60 |
| 11.064.62 | 7 | 62 |
| 11.064.64 | 7 | 64 |
| 11.064.67 | 7 | 67 |
| 11.064.68 | 7 | 68 |
| 11.064.76 | 7 | 76 |
| 11.064.78 | 7 | 78 |
| 11.064.79 | 7 | 79 |

CONNECTING SYSTEM diam 10 mm
ZŁĄCZA BARYŁKOWE Ø 10

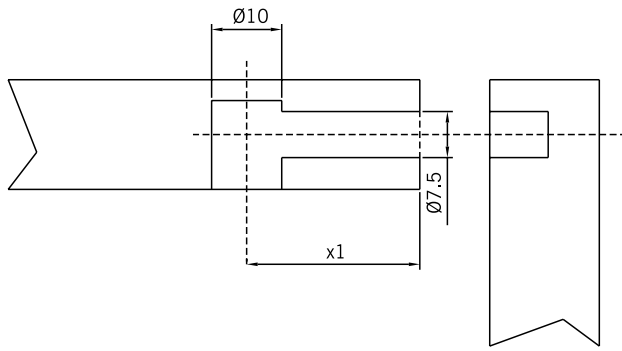

CROSS DOWELS without collar
BARYŁKI 10 MM bez kołnierza

| Art. | b | l [mm] | x [mm] |
|--------|----|--------|--------|
| 11.110 | M6 | 26 | 19 |
| 11.111 | M6 | 22 | 17 |
| 11.112 | M6 | 18 | 14 |
| 11.113 | M6 | 16 | 13 |
| 11.114 | M6 | 14 | 12,5 |

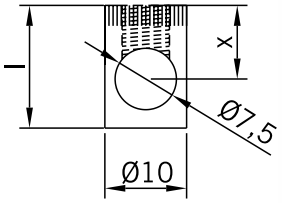

DOWELS FOR BARREL SYSTEM diam 7 mm
ZACZEPY DO ZŁĄCZ średnica 7 mm

| Art. | b | Ø [mm] | l [mm] | x | n |
|---------|----|--------|--------|------|---|
| GB.2907 | M6 | 7 | 35 | 20 | 9 |
| GB.3007 | M6 | 7 | 34 | 18,5 | 9 |
| GB.3107 | M6 | 7 | 45 | 30 | 9 |
| GB.3207 | M6 | 7 | 45 | 28,5 | 9 |

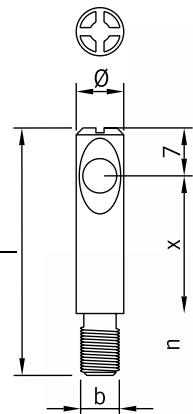

STOP SCREWS
WKRETY KONTROLUJĄCE

| Art. | b | l [mm] |
|--------|----|--------|
| 11.115 | M6 | 14 |
| 11.116 | M6 | 11 |
| 11.117 | M6 | 8 |

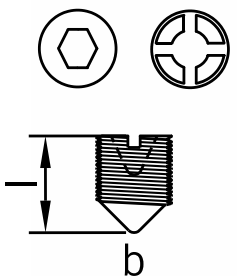

SYSTEMY POŁĄCZEŃ

SYSTEMY POŁĄCZEŃ

CONNECTING SYSTEM diam 14 mm
ZŁĄCZA BARYŁKOWE Ø 14



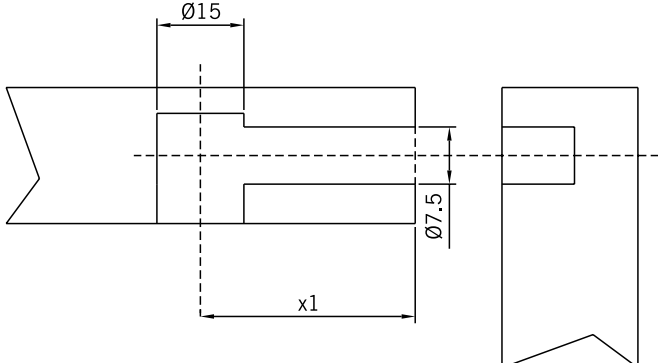
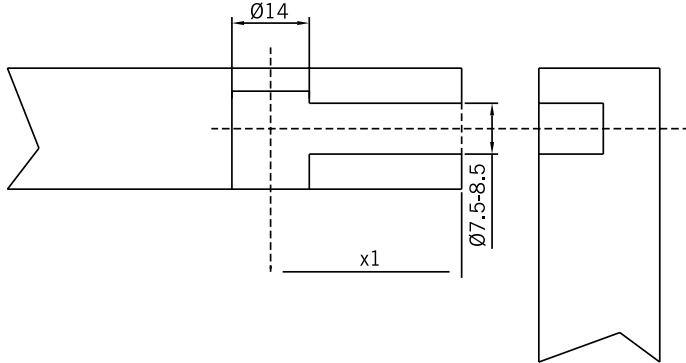

CONNECTING SYSTEM diam 15 mm
ZŁĄCZA BARYŁKOWE Ø 15



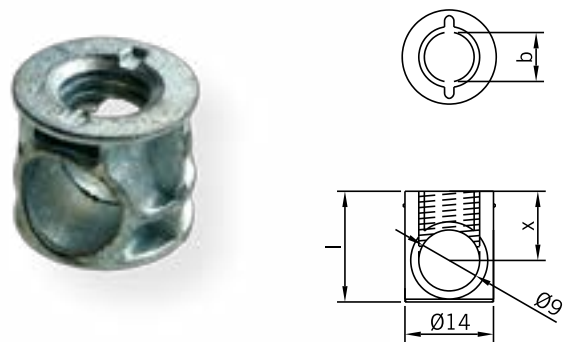

CROSS DOWELS without collar
BARYŁKI 14 MM bez kołnierza

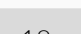
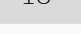
CROSS DOWELS without collar
BARYŁKI 15 MM bez kołnierza

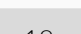
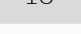

| Art. | b |  | l [mm] | x [mm] |
|--------|----|---|--------|--------|
| 11.120 | M8 |  | 16 | 13 |
| 11.121 | M8 |  | 18 | 14 |
| 11.122 | M8 |  | 20 | 15 |
| 11.123 | M8 |  | 25 | 18 |

| Art. | b |  | l [mm] | x [mm] |
|--------|----|---|--------|--------|
| 11.150 | M8 |  | 20 | 15 |
| 11.151 | M8 |  | 18 | 14,5 |
| 11.152 | M8 |  | 18 | 13,5 |

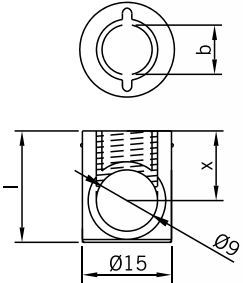

DOWELS FOR BARREL SYSTEM diam 7 mm
ZACZEPY DO ZŁĄCZ średnica 7 mm

DOWELS FOR BARREL SYSTEM diam 7 mm
ZACZEPY DO ZŁĄCZ średnica 7 mm

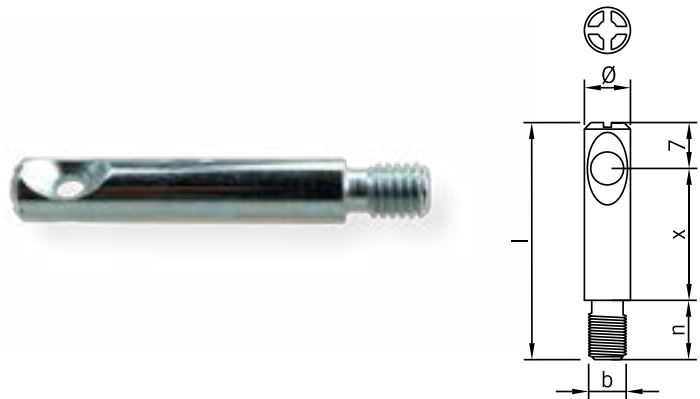

| Art. | b | Ø [mm] | l [mm] | x | n |
|---------|----|--------|--------|------|---|
| GB.2907 | M6 | 7 | 36 | 20 | 9 |
| GB.3007 | M6 | 7 | 34 | 18,5 | 9 |
| GB.3107 | M6 | 7 | 45 | 30 | 9 |
| GB.3207 | M6 | 7 | 45 | 28,5 | 9 |

| Art. | b | Ø [mm] | l [mm] | x | n |
|--------|------|--------|--------|----|----|
| 11.153 | EURO | 7 | 51,5 | 34 | 11 |
| 11.154 | EURO | 7 | 41,5 | 24 | 11 |
| 11.155 | M6 | 7 | 48,5 | 34 | 8 |
| 11.156 | M6 | 7 | 38,5 | 24 | 8 |

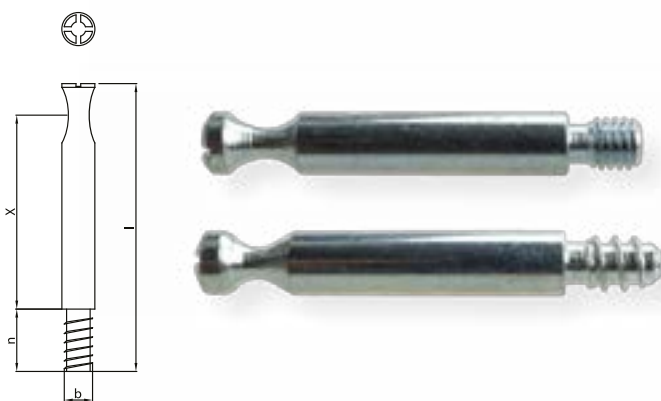

STOP SCREWS
WKRETY KONTRUJĄCE

STOP SCREWS
WKRETY KONTRUJĄCE



| Art. | b | l [mm] |
|--------|----|--------|
| 11.124 | M8 | 10 |
| 11.125 | M8 | 12,5 |

| Art. | b | l [mm] |
|--------|----|--------|
| 11.157 | M8 | 6 |
| 11.158 | M8 | 8 |

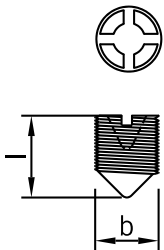

CONNECTING SYSTEM diam 16 mm
ZŁĄCZA BARYŁKOWE Ø 16

DOUBLE DOWELS
ZACZEPY PODWÓJNE

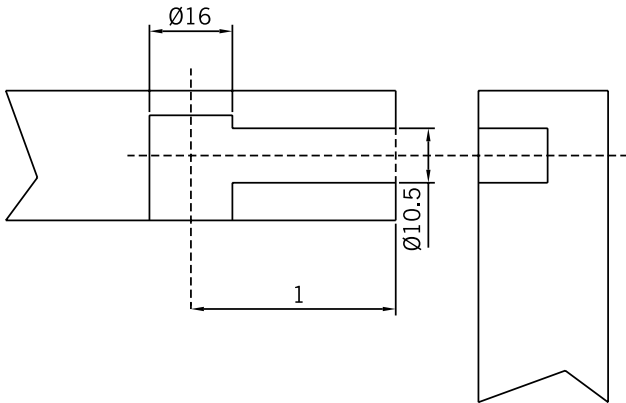

| Art. | Ø [mm] | L [mm] | X [mm] |
|---------|--------|--------|--------|
| GB.3307 | 10 | 8 | 60 |
| GB.4107 | 10 | 7 | 60 |
| GB.5507 | 10 | 7 | 62 |

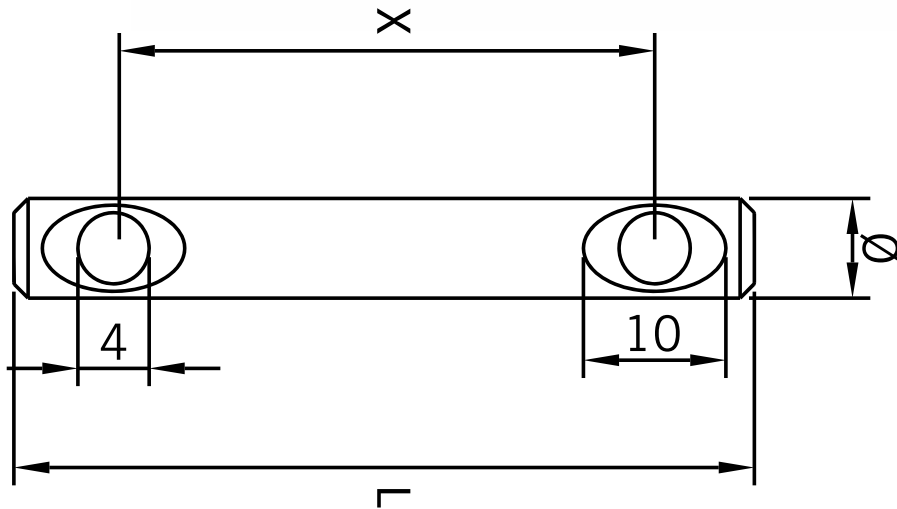

CROSS DOWELS without collar
BARYŁKI 16 MM bez kołnierza

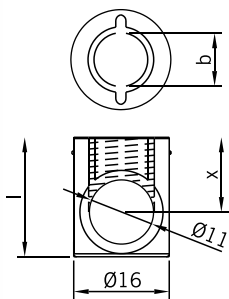

| Art. | b | l [mm] | x [mm] |
|--------|-----|--------|--------|
| 11.130 | M10 | 30 | 24 |
| 11.131 | M10 | 25 | 20 |
| 11.132 | M10 | 22 | 18 |

DOWELS FOR BARREL SYSTEM diam 10 mm
ZACZEPY DO ZŁĄCZ średnica 10 mm

ANGLE DOWELS
ZACZEPY KĄTOWE

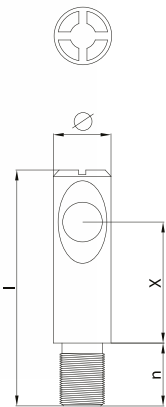

| Art. | b | Ø [mm] | l [mm] | x | n |
|--------|----|--------|--------|----|---|
| 11.133 | M6 | 10 | 45 | 30 | 9 |
| 11.134 | M8 | 10 | 45 | 30 | 9 |
| 11.135 | M6 | 10 | 36 | 20 | 9 |
| 11.136 | M8 | 10 | 36 | 20 | 9 |

| Art. | Ø [mm] | X [mm] |
|---------|--------|--------|
| GB.3407 | 8 | 45 |

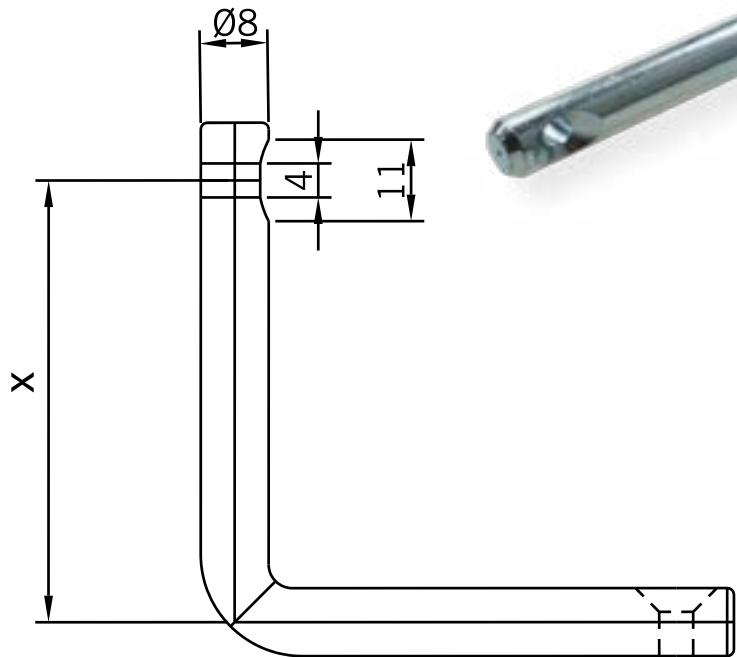

STOP SCREWS
WKRETY KONTRUJĄCE



| Art. | b | l [mm] |
|--------|-----|--------|
| 11.137 | M10 | 12 |
| 11.138 | M10 | 16 |

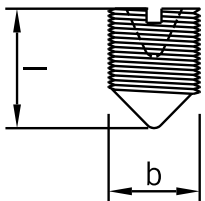

MINI MOON LINE nylon washers
PODKŁADKI TWORZYWOWE

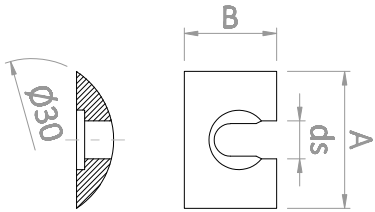

| Art. | A | B | ds |
|-------------|------|----|----|
| 62701000030 | 25,2 | 17 | 6 |

MOON LINE sector parts
PODKŁADKI MOON LINE

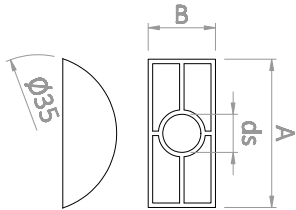

| Art. | A | B | ds |
|--------|----|------|-----|
| 16.303 | 30 | 14,5 | 8,2 |

MOON LINE sector parts
PODKŁADKI MOON LINE

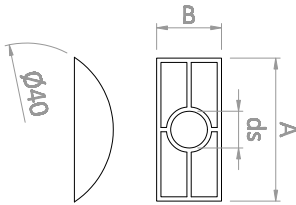

| Art. | A | B | ds |
|--------|----|----|-----|
| 16.301 | 32 | 15 | 8,2 |

MAXI MOON LINE nylon washers
PODKŁADKI MAXI MOON LINE

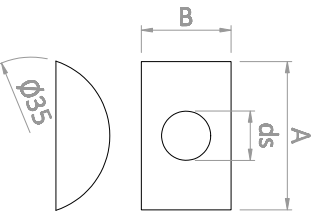

| Art. | A | B | ds |
|--------|----|----|------|
| 16.302 | 32 | 20 | 10,2 |

STEEL M6 sector parts
PODKŁADKI Z GWINTEM M6

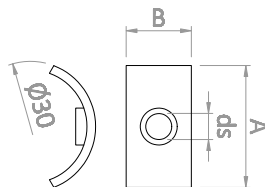

| Art. | A | B | ds |
|------------|----|----|----|
| 6610100000 | 26 | 13 | M6 |

STEEL sector parts
PODKŁADKI STALOWE

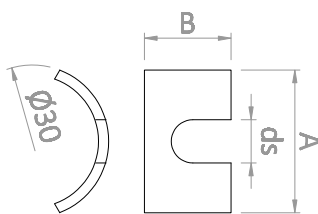

| Art. | A | B | ds |
|------------|----|----|-----|
| 6600100000 | 26 | 13 | 6,2 |

ASYMETRIC BARREL NUTS
NAKRĘTKI WAŁECZKOWE asymetryczne

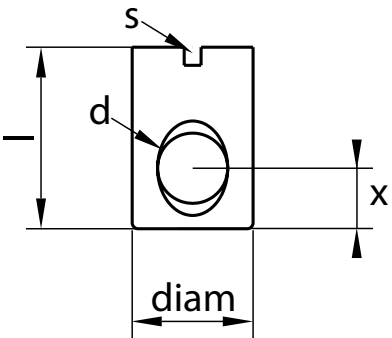

| Art. | d | diam] | l [mm] | x | s |
|-----------|----|-------|--------|---|-----|
| 16.350 | M6 | 10 | 13 | 5 | 1,6 |
| 16.350.16 | M6 | 10 | 16 | 5 | 1,6 |
| 16.350.20 | M6 | 10 | 20 | 5 | 1,6 |

SYMETRIC BARREL NUTS
NAKRĘTKI WAŁECZKOWE symetryczne

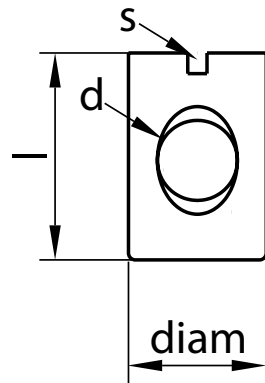

| Art. | d | diam | l [mm] | s |
|-------------|----|------|--------|-----|
| 16.350.1 | M6 | 10 | 13 | 1,6 |
| 16.350.1.20 | M6 | 10 | 20 | 1,6 |
| 16.351.14 | M8 | 12 | 14 | 1,6 |
| 16.351.18 | M8 | 12 | 18 | 1,6 |
| 16.351.25 | M8 | 12 | 25 | 1,6 |
| 16.351.30 | M8 | 12 | 30 | 1,6 |

BARREL NUTS with two holes
NAKRĘTKI WAŁECZKOWE 2 otworowe

| Art. | d | diam | l [mm] | x1 | s |
|--------|----|------|--------|----|-----|
| 16.353 | M6 | 10 | 60 | 32 | 1,6 |
| 16.352 | M8 | 12 | 60 | 32 | 1,6 |

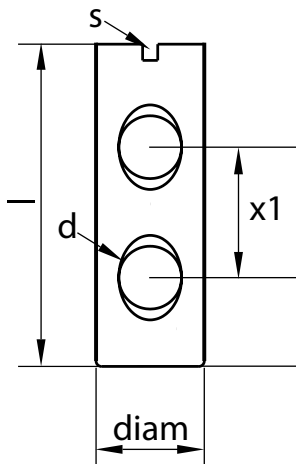

ECM CONNECTOR 25 mm hole
ZŁĄCZA ECM Ø 25 mm



EXCENTER diam 25 mm
MIMOŚRODY Ø 25 mm

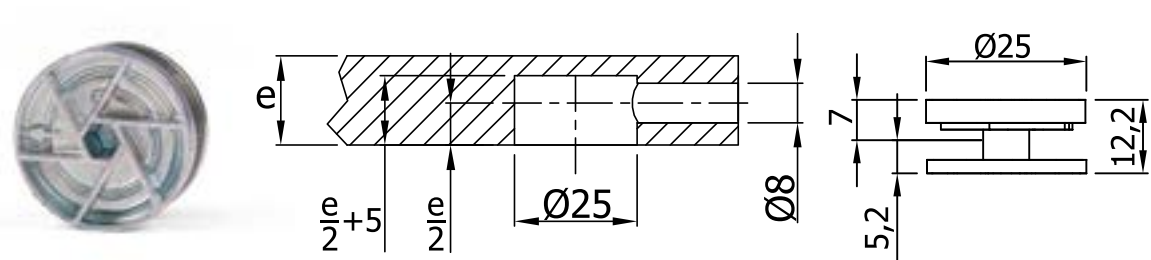

Art.
240012500Z

DOWELS
ZACZEPY POJEDYNCZE

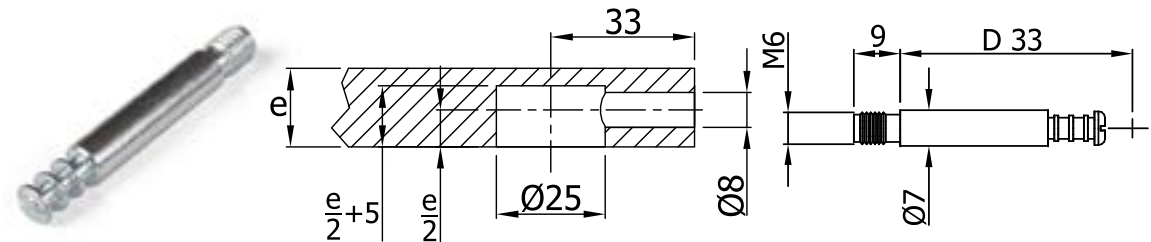

Art.
2450106033Z

DOUBLE DOWELS
ZACZEPY PODWÓJNE

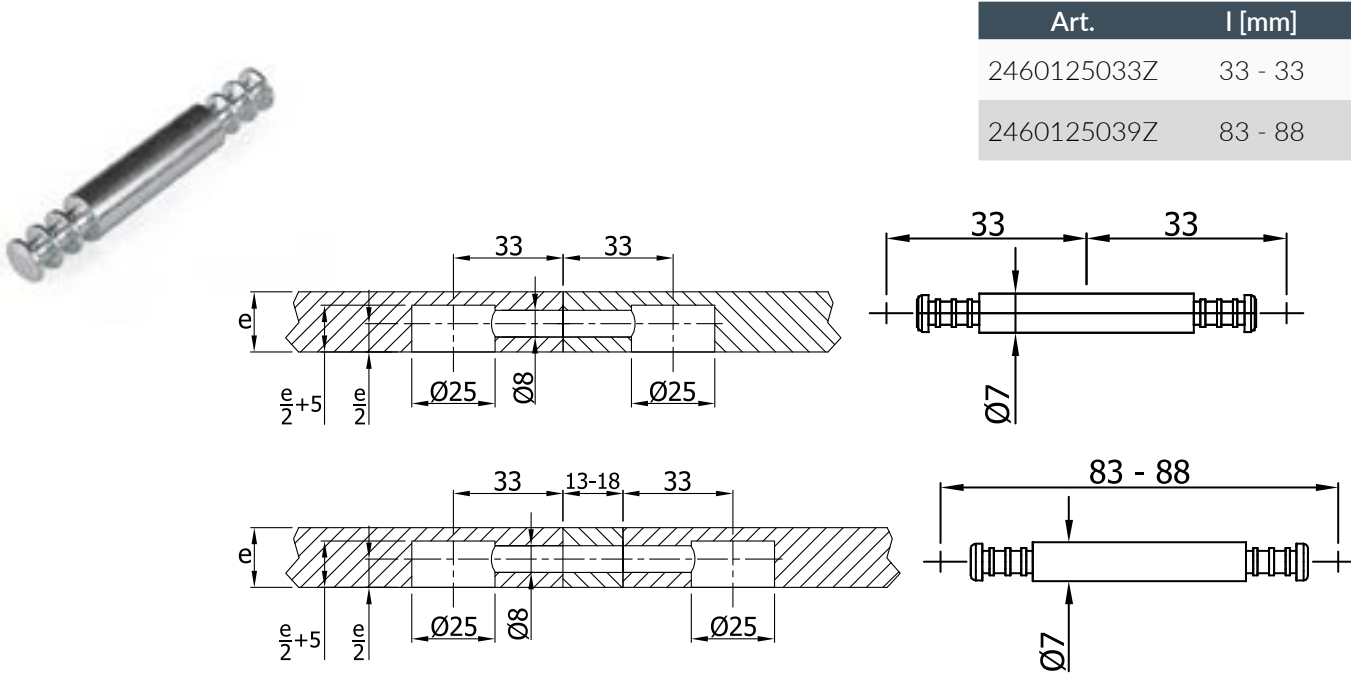

| Art. | l [mm] |
|-------------|---------|
| 2460125033Z | 33 - 33 |
| 2460125039Z | 83 - 88 |

ANGLE DOWELS 90°
ZACZEPY KĄTOWE 90°

Art.
2470140040Z

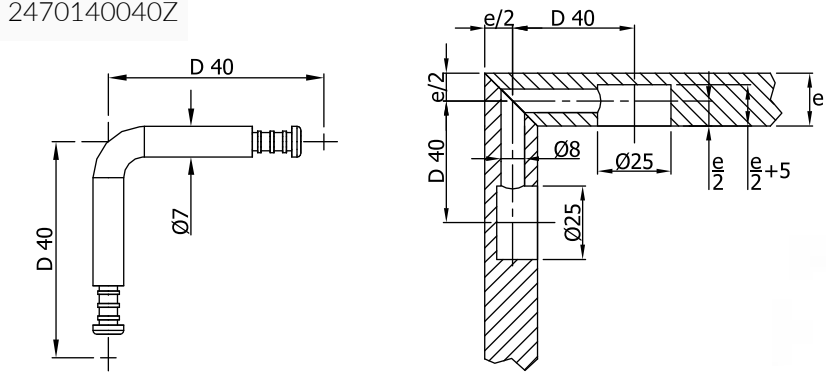

FEMALE DOWELS M6
ZACZEPY NA SZPILKĘ M6

Art.
2480170226Z

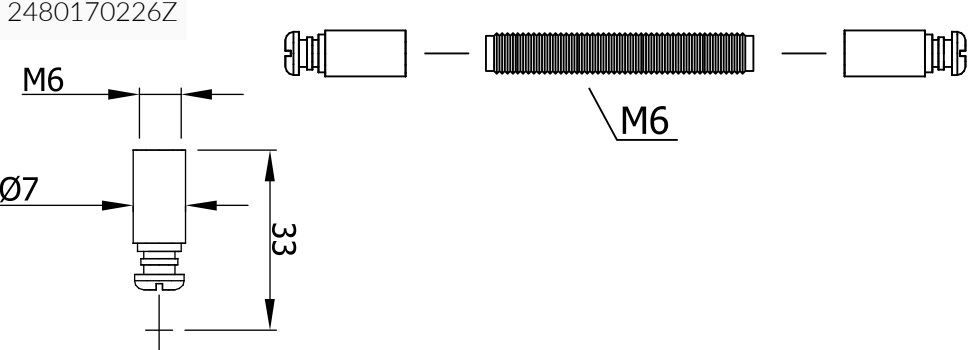

FLEX'O DOWELS
ZACZEPY FLEX'O

Art.
2490120206Z

60° - 180°

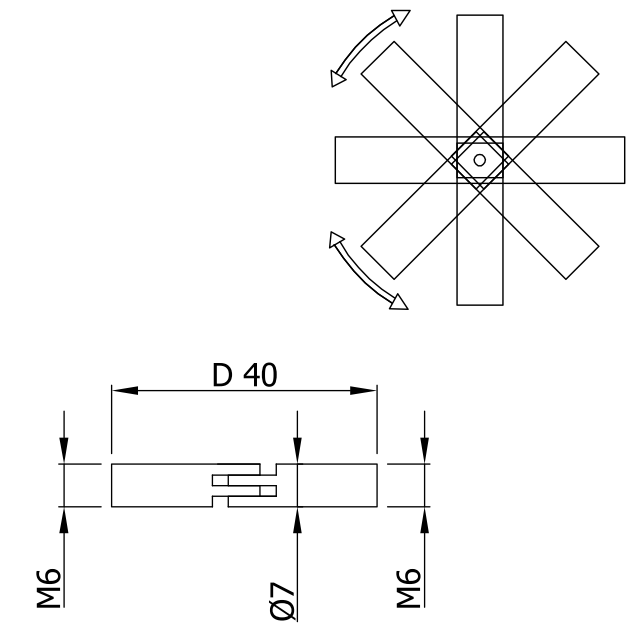

BMZ CONNECTION Ø 35 mm hole
ZŁĄCZA BMZ Ø 35 mm

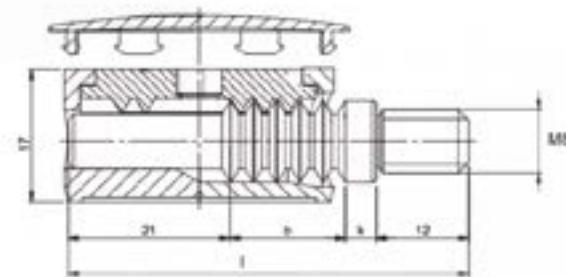

| Art. | I |
|-------------|----|
| 255G008052Z | 52 |
| 255G008064Z | 64 |
| 255G008084Z | 84 |

CONNECTING FITTINGS 180 ST. pilot hole 35 mm
ZŁĄCZA DO BLATÓW

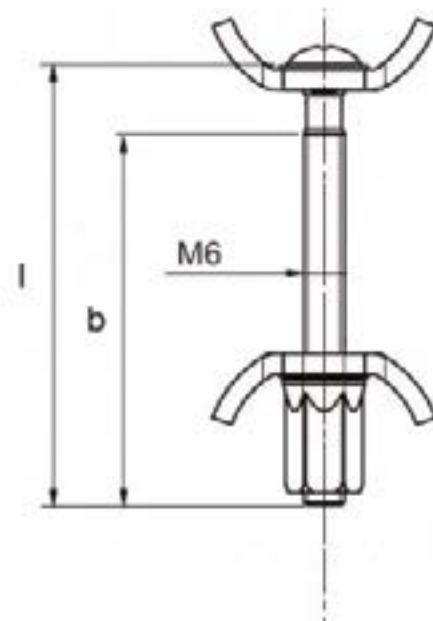
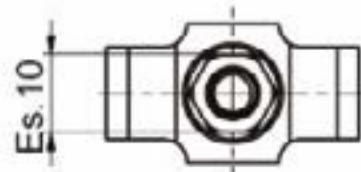
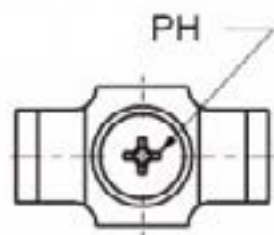

| Art. | l | b | ph |
|-------------|-----|----|----|
| 665G006065Z | 65 | 55 | 2 |
| 665G006080Z | 80 | 65 | 2 |
| 665G006100Z | 100 | 90 | 2 |
| 665G006120Z | 120 | 95 | 2 |
| 665G006130Z | 130 | 95 | 2 |
| 665G006150Z | 150 | 95 | 2 |

CONNECTING FITTINGS / SYSTEMY POŁĄCZEŃ

BED CONNECTOR set
ZACZEPY GRZEBIENIOWY ŁÓŻKA komplet

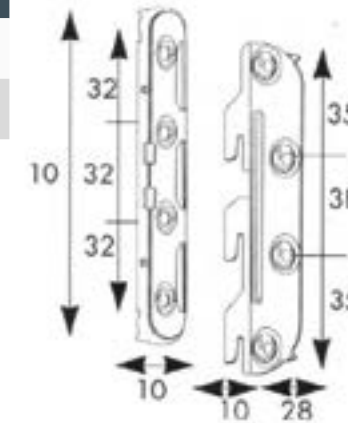

BED CONNECTOR with adjustable
ZACZEPY BELKI ŁÓŻKA 4 stopniowy

| Art. | H [mm] |
|--------|--------|
| 11.218 | 100 |
| 11.203 | 130 |

Art.
11.204

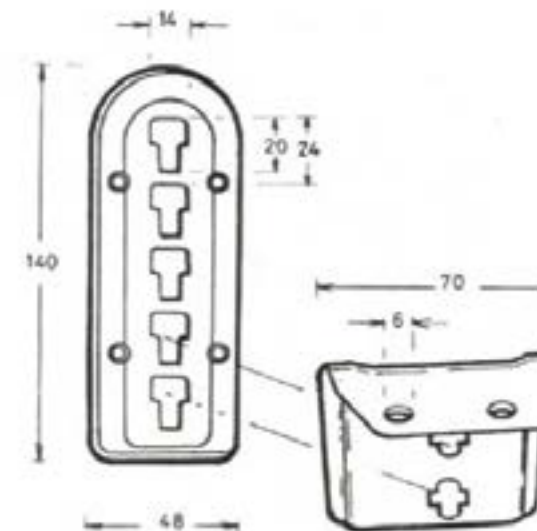

BED CONNECTOR without adjustable
ZACZEPY BELKI ŚRODKOWEJ ŁÓŻKA

Art.
11.205

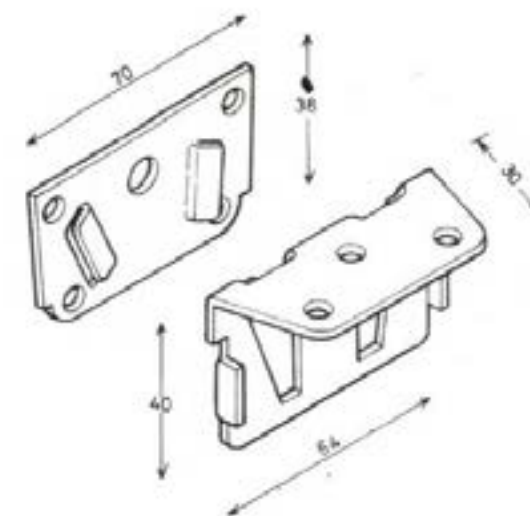

ANGLE BRACKET for beds
KĄTOWNIKI STALOWE do łóżka

ALLEN KEYS L SHAPE hardening
KLUCZE IMBUSOWE TYP L hartowane

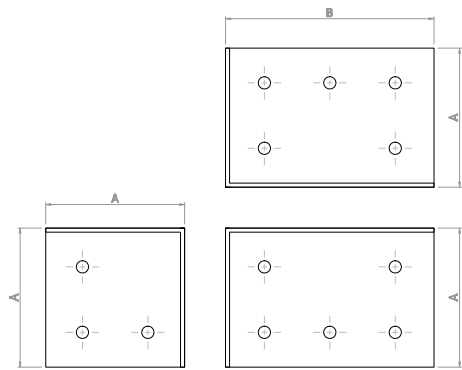

| Art. | A [mm] | B [mm] |
|--------|--------|--------|
| 11.220 | 67 | 104 |

| Art. | S [mm] |
|------------|--------|
| 566C820000 | 2 |
| 566C825000 | 2,5 |
| 566C830000 | 3 |
| 566C840000 | 4 |
| 566C850000 | 5 |
| 566C860000 | 6 |
| 566A080000 | 8 |

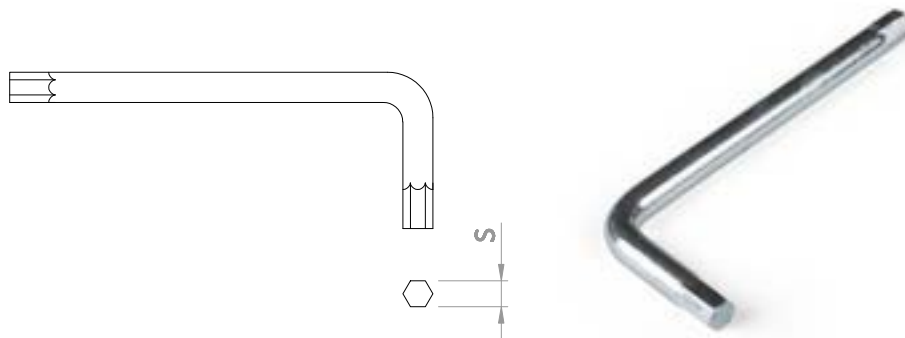

ANGLE BRACKET for beds
KĄTOWNIKI STALOWE do łóżka

ALLEN KEYS Z SHAPE hardening
KLUCZE IMBUSOWE TYP Z hartowane

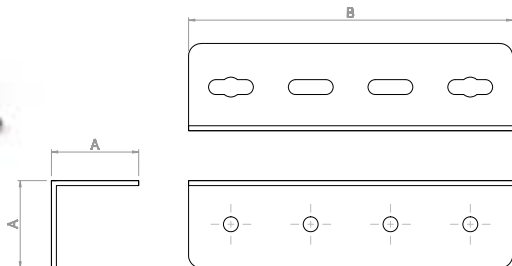

| Art. | A [mm] | B [mm] |
|--------|--------|--------|
| 11.209 | 34 | 130 |

| Art. | S [mm] |
|------------|--------|
| 624C840000 | 4 |
| 624C850000 | 5 |

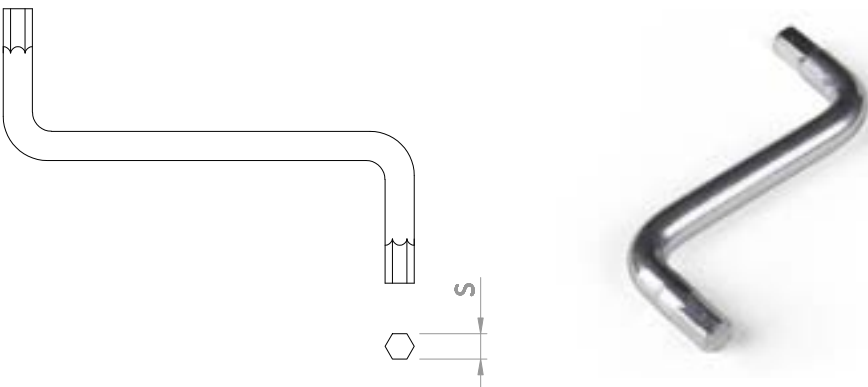

DISTANCE FOR BED LEGS Ø 35 mm hole
PRZEDŁUŻKA DO NÓG Ø 35 mm

ALLEN KEYS L SHAPE hex
KLUCZE IMBUSOWE TYP L sześciokątne

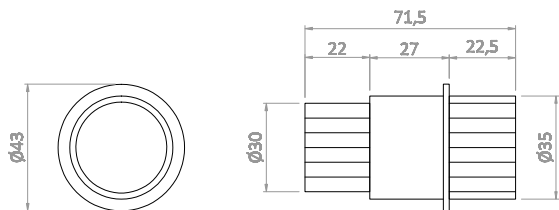

| Art. |
|----------|
| 15.026.1 |

| Art. | S [mm] |
|-----------|--------|
| 625L40000 | 4 |
| 625L50000 | 5 |
| 625L60000 | 6 |

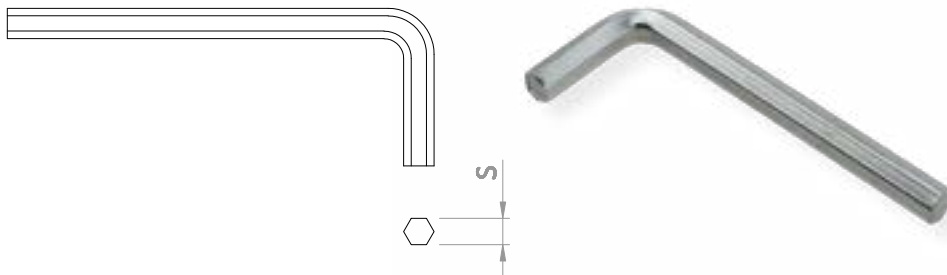

ADJUSTABLE FOOT FOR BED Ø 35 mm hole
NOGI REGULOWANE DO ŁÓŻKA Ø 35 mm

ALLEN KEYS Z SHAPE hex
KLUCZE IMBUSOWE TYP Z sześciokątne



| Art. | L [mm] |
|----------|-----------|
| 15.026 | 200 - 260 |
| 15.026.3 | 134 - 217 |

| Art. | S [mm] |
|-----------|--------|
| 625Z40000 | 4 |
| 625Z50000 | 5 |
| 625Z60000 | 6 |

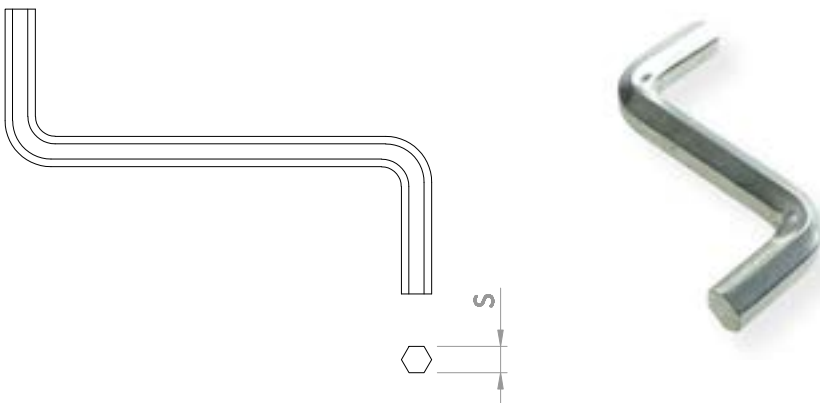

CONNECTION JOINT M4
ZŁĄCZA MEBLOWE M4

CONNECTION JOINTS M6
ZŁĄCZA MEBLOWE M6

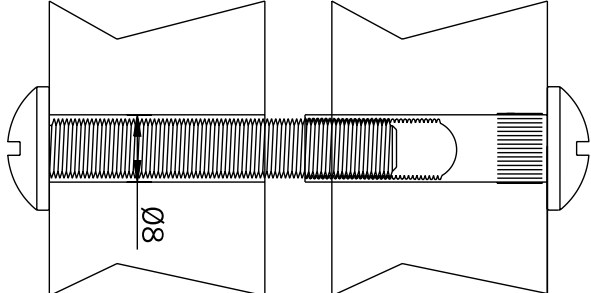
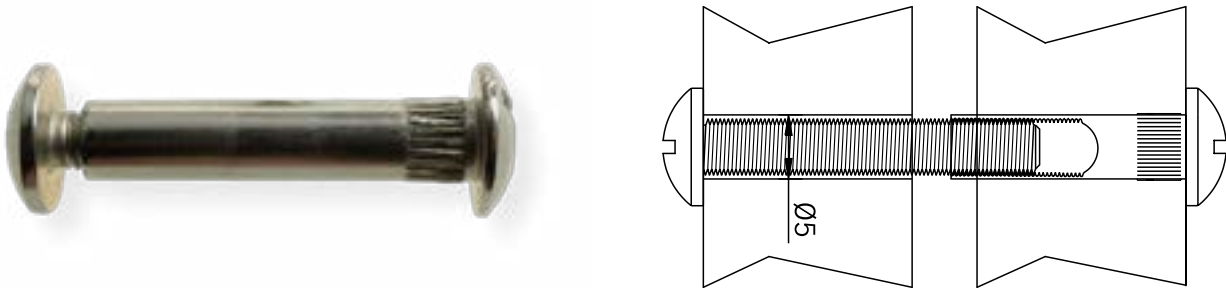

FEMALE SCREWS round head
CZĘŚCI DAMSKIE M4

FEMALE SCREWS round head
CZĘŚCI DAMSKIE M6

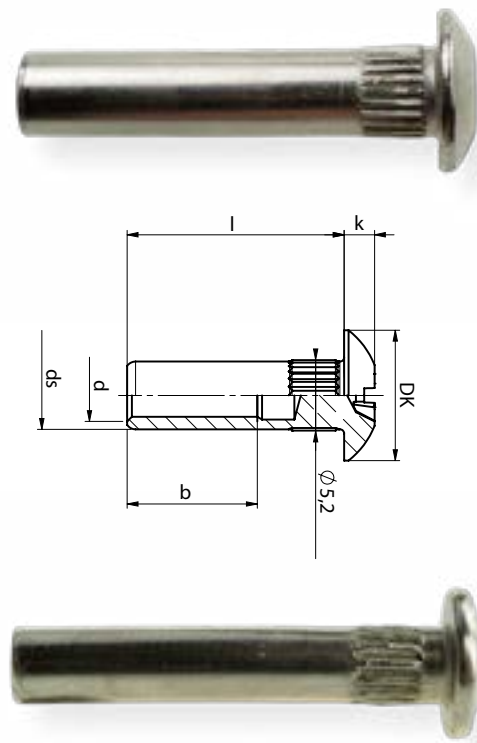

| Art. | DK [mm] | d | ds [mm] | k [mm] | b [mm] | l [mm] |
|------------|---------|----|---------|--------|--------|--------|
| 565A004015 | 10 | M4 | 5 | 2,5 | 9,5 | 15 |
| 565A004020 | 10 | M4 | 5 | 2,5 | 14 | 20 |
| 565A004027 | 10 | M4 | 5 | 2,5 | 14,5 | 27 |
| 565A004030 | 10 | M4 | 5 | 2,5 | 14,5 | 30 |
| 565A004035 | 10 | M4 | 5 | 2,5 | 14,5 | 35 |

| Art. | DK [mm] | d | ds [mm] | k [mm] | b [mm] | l [mm] |
|------------|---------|----|---------|--------|--------|--------|
| 497A004015 | 10 | M4 | 5 | 1,5 | 10 | 15 |
| 497A004028 | 10 | M4 | 5 | 1,5 | 14,5 | 28 |

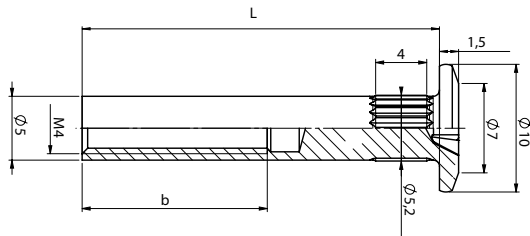

| Art. | DK [mm] | d | ds | k [mm] | b | l [mm] |
|------------|---------|----|-----|--------|------|--------|
| 555A006012 | 15 | M6 | 7,8 | 3,5 | 6,5 | 12 |
| 555A006015 | 15 | M6 | 7,8 | 3,5 | 9,5 | 15 |
| 555A006020 | 15 | M6 | 7,8 | 3,5 | 14,5 | 20 |
| 555A006025 | 15 | M6 | 7,8 | 3,5 | 15 | 25 |
| 555A006028 | 15 | M6 | 7,8 | 3,5 | 15 | 28 |
| 555A006031 | 15 | M6 | 7,8 | 3,5 | 15 | 31 |
| 555A006038 | 15 | M6 | 7,8 | 3,5 | 15 | 38 |

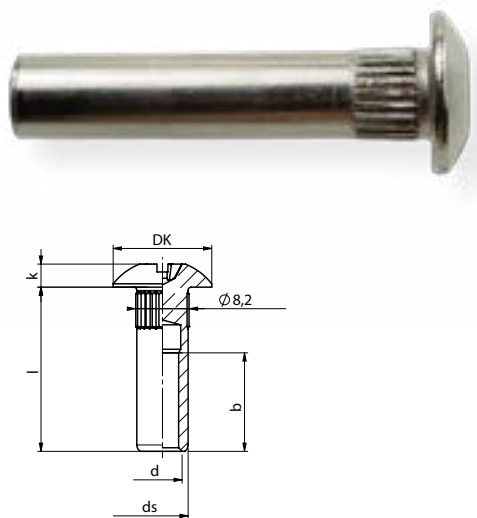

METAL SCREWS round head
CZĘŚCI MĘSKIE M4

MALE SCREWS round head
CZĘŚCI MĘSKIE M6

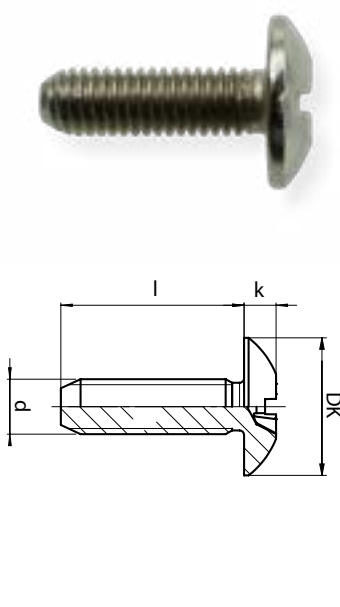

| Art. | DK [mm] | d | k [mm] | l [mm] |
|------------|---------|----|--------|--------|
| 565H104015 | 10 | M4 | 2,5 | 15 |

| Art. | DK [mm] | d | k [mm] | l [mm] |
|------------|---------|----|--------|--------|
| 497C404011 | 10 | M4 | 1,5 | 11 |
| 497C404015 | 10 | M4 | 1,5 | 15 |
| 497C404028 | 10 | M4 | 1,5 | 28 |

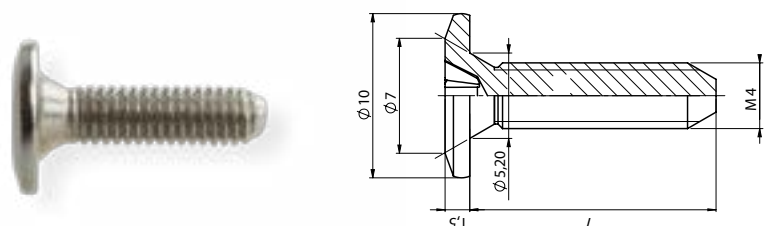

| Art. | DK [mm] | d | k [mm] | l [mm] |
|------------|---------|----|--------|--------|
| 555C406014 | 15 | M6 | 3,5 | 14 |
| 555C406016 | 15 | M6 | 3,5 | 16 |
| 555C406020 | 15 | M6 | 3,5 | 20 |

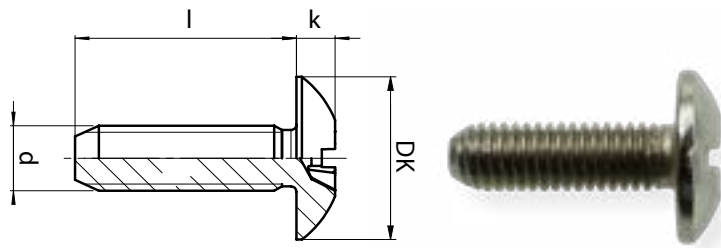

IRON PLATES
PŁYTKI MONTAŻOWE

IRON BRACKETS
KĄTOWNIKI MONTAŻOWE





21.0701.P 50 × 60 MM





21.0702.P 45 × 45 MM

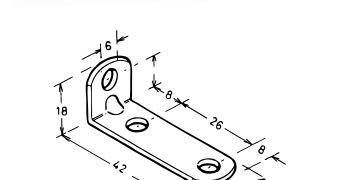

21.0733.P 15 × 60 MM



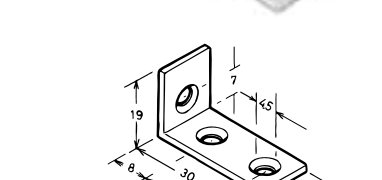

21.0707 42 × 18 MM





21.0718.P 42 × 18 × 1,8 MM

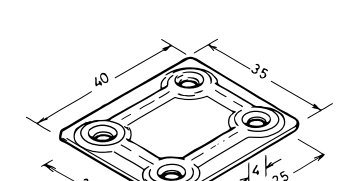



21.0733.50P 15 × 100 MM

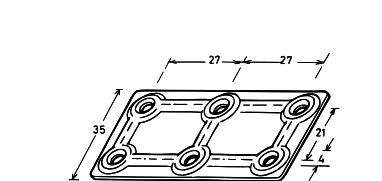

21.0713.P 40 × 35 MM

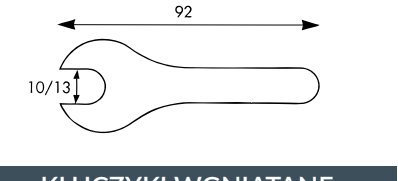

21.0713 70 × 35 MM



KLUCZYKI WGNIAKANE

| | |
|--------|-------------------|
| 16.202 | M6 / 10 MM |
| 16.201 | M8 / 13 MM |
| 16.203 | M10 / 17 MM |
| 16.204 | M5 8MM / M8 10 MM |



21.0707 25 × 25 MM





21.0732 25 × 50 MM



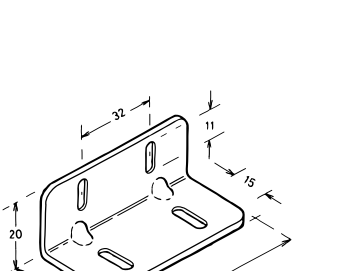

21.00ALM 26 × 31 MM

IRON BRACKETS
KĄTOWNIKI MONTAŻOWE

IRON BRACKETS
KĄTOWNIKI MONTAŻOWE - RÓŻNE TYPY

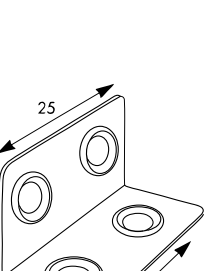

21.0701 20 × 30 × 60 MM



21.0702.G 22 × 22 × 45 MM

| Art. | Wymiar |
|-----------|------------|
| 21.0733.2 | 20 × 20 MM |
| 21.0733.3 | 30 × 30 MM |
| 21.0733.4 | 40 × 40 MM |
| 21.0733.5 | 50 × 50 MM |
| 21.0733.6 | 60 × 60 MM |

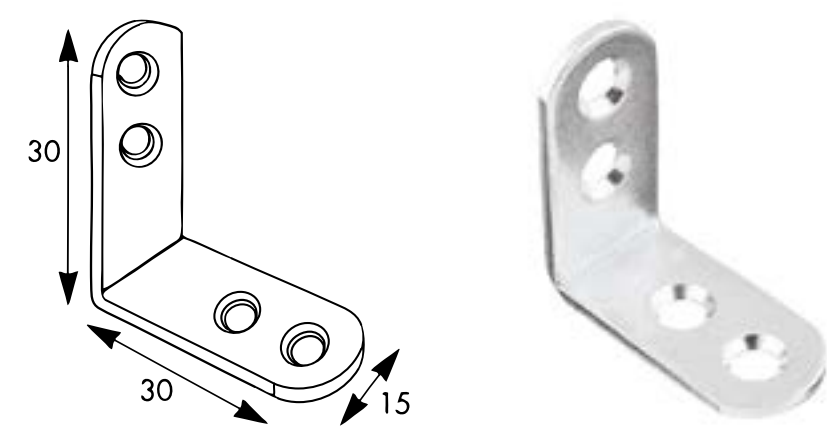

ADJUSTABLE FEET round base
REGULATORY WYSOKOŚCI podstawa okrągła

ADJUSTABLE FEET WITH HEX, PZD round base
REGULATORY WYSOKOŚCI, PZD podstawa okrągła



| Art. | d | DK [mm] | L [mm] | L1 [mm] | COLOUR |
|----------|----|---------|--------|---------|--------|
| 15.023 | M6 | 17 | 20 | 27 | ● |
| 15.023.1 | M6 | 17 | 20 | 27 | ● |
| 15.023.2 | M6 | 17 | 20 | 27 | ● |

| Art. | d | DK [mm] | L [mm] | L1 [mm] | COLOUR |
|----------|----|---------|--------|---------|--------|
| 15.001 | M6 | 19 | 20 | 27 | ● |
| 15.001.1 | M6 | 19 | 20 | 27 | ● |
| 15.001.2 | M6 | 19 | 20 | 27 | ● |

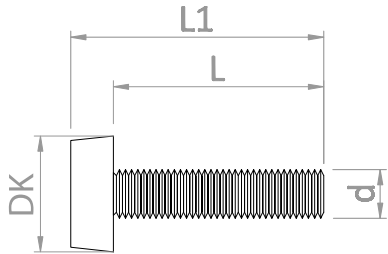

| Art. | d | DK [mm] | k [mm] | l [mm] | l1 [mm] |
|------------|----|---------|--------|--------|---------|
| 290G008030 | M8 | 20 | 5 | 30 | 35 |
| 290G008035 | M8 | 20 | 5 | 35 | 40 |
| 290G008040 | M8 | 20 | 5 | 40 | 45 |
| 290G008045 | M8 | 20 | 5 | 45 | 50 |
| 290G008050 | M8 | 20 | 5 | 50 | 55 |
| 290G008060 | M8 | 20 | 5 | 60 | 65 |
| 290G008070 | M8 | 20 | 5 | 70 | 75 |
| 290G008080 | M8 | 20 | 5 | 80 | 85 |
| 290G008090 | M8 | 20 | 5 | 90 | 95 |
| 290G008100 | M8 | 20 | 5 | 100 | 105 |

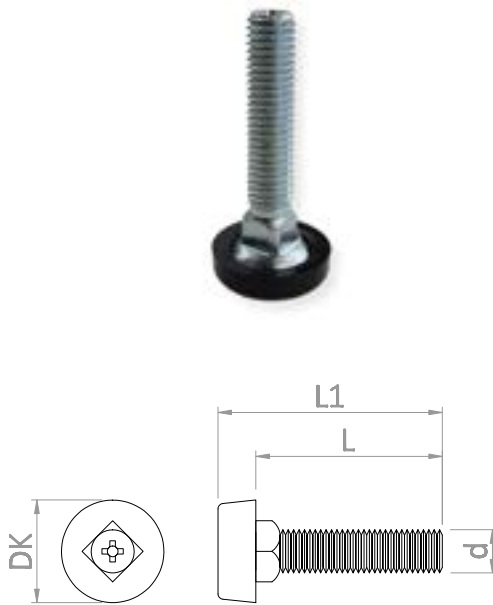

ADJUSTABLE FEET hex base
REGULATORY WYSOKOŚCI podstawa sześciokątna

ADJUSTABLE FEET SLOT CUT round base with plug
REGULATORY WYSOKOŚCI NACIĘCIE PROSTE podstawa okrągła



| Art. | d | SW [mm] | L [mm] | L1 [mm] | COLOUR |
|--------|----|---------|--------|---------|--------|
| 15.004 | M6 | 17 | 20 | 27 | ● |
| 15.024 | M6 | 15 | 20 | 27 | ● |

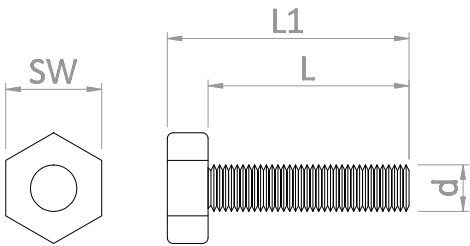

| Art. | d | DK [mm] | l [mm] |
|------------|-----|---------|--------|
| 301G008030 | M8 | 33 | 30 |
| 301G008040 | M8 | 33 | 40 |
| 301G008050 | M8 | 33 | 50 |
| 301G008060 | M8 | 33 | 60 |
| 301G008070 | M8 | 33 | 70 |
| 301G008080 | M8 | 33 | 80 |
| 301G008090 | M8 | 33 | 90 |
| 301G008100 | M8 | 33 | 100 |
| 301G008110 | M8 | 33 | 110 |
| 301G008120 | M8 | 33 | 120 |
| 301G008150 | M8 | 33 | 150 |
| 301G010035 | M10 | 33 | 35 |
| 301G010040 | M10 | 33 | 40 |
| 301G010050 | M10 | 33 | 50 |
| 301G010060 | M10 | 33 | 60 |
| 301G010070 | M10 | 33 | 70 |
| 301G010080 | M10 | 33 | 80 |
| 301G010090 | M10 | 33 | 90 |
| 301G010100 | M10 | 33 | 100 |
| 301G010120 | M10 | 33 | 120 |

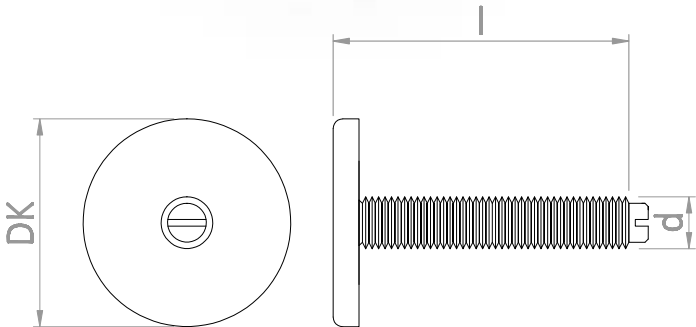

ADJUSTABLE FEET round base
REGULATORY WYSOKOŚCI podstawa okrągła

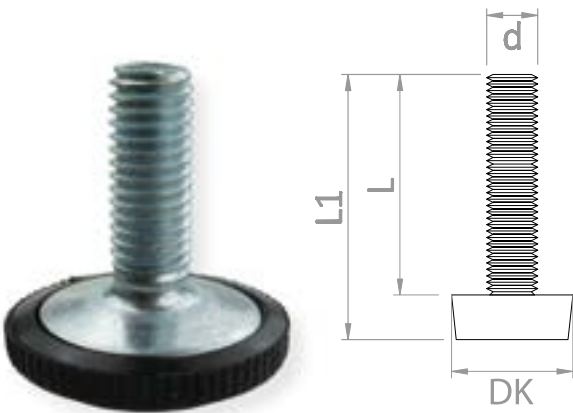

| Art. | d | DK [mm] | L [mm] | L1 [mm] |
|------------|-----|---------|--------|---------|
| 300G006015 | M6 | 21 | 15 | 22 |
| 300G006020 | M6 | 21 | 20 | 27 |
| 300G006025 | M6 | 21 | 25 | 32 |
| 300G008022 | M8 | 28 | 22 | 30 |
| 300G008038 | M8 | 28 | 38 | 46 |
| 300G010025 | M10 | 32 | 25 | 34 |

ADJUSTABLE FEET HEX CUT round base
REGULATORY WYSOKOŚCI NA IMBUS podstawa okrągła

ADJUSTABLE FEET round base 2500 kg
REGULATORY WYSOKOŚCI podstawa okrągła

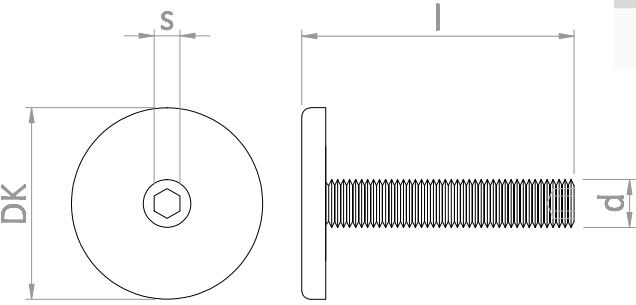

| Art. | d | DK [mm] | s [mm] | l [mm] |
|------------|-----|---------|--------|--------|
| 3041008040 | M8 | 30 | 4 | 40 |
| 3041008050 | M8 | 30 | 4 | 50 |
| 3041008060 | M8 | 30 | 4 | 60 |
| 3041008065 | M8 | 30 | 4 | 65 |
| 304100861D | M8 | 30 | 4 | 61,2 |
| 3041010032 | M10 | 30 | 4 | 32 |
| 3041010060 | M10 | 30 | 4 | 60 |
| 3041010070 | M10 | 30 | 4 | 70 |
| 3041010080 | M10 | 30 | 4 | 80 |
| 3041010100 | M10 | 30 | 4 | 100 |
| 3041010120 | M10 | 30 | 4 | 120 |

| Art. | d | DK [mm] | k [mm] | s | l [mm] | l1 [mm] |
|------------|-----|---------|--------|----|--------|---------|
| 720G010056 | M10 | 49,3 | 10,5 | 10 | 56 | 42 |



ADJUSTABLE FEET with bracket
REGULATORY WYSOKOŚCI z kątownikiem

| Art. | d | s |
|--------------------|----|---|
| 3064308060 - RIGHT | M8 | 4 |
| 3064308060 - LEFT | M8 | 4 |



ADJUSTABLE FEET hex base
REGULATORY WYSOKOŚCI podstawa sześciokątna

| Art. | d | DK [mm] | k [mm] | l [mm] | COLOUR |
|-------------|----|---------|--------|--------|--------|
| 604G6000009 | M6 | 12 | 6 | 15 | ● |
| 604G000000D | M6 | 12 | 6 | 15 | ● |



ADJUSTABLE FEET HEX CUT round base with plug
REGULATORY WYSOKOŚCI NA IMBUS podstawa okrągła

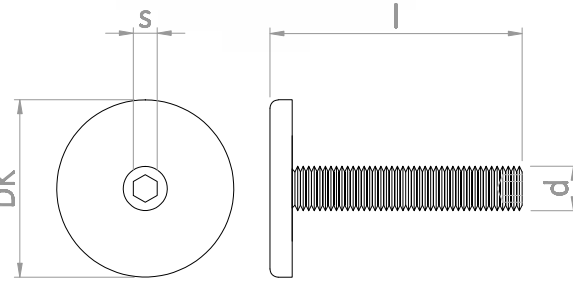

| Art. | d | DK [mm] | s [mm] | l [mm] |
|------------|-----|---------|--------|--------|
| 304G008040 | M8 | 33 | 4 | 40 |
| 304G008045 | M8 | 33 | 4 | 45 |
| 304G008050 | M8 | 33 | 4 | 50 |
| 304G008060 | M8 | 33 | 4 | 60 |
| 304G008065 | M8 | 33 | 4 | 65 |
| 304G010032 | M10 | 33 | 4 | 32 |
| 304G010040 | M10 | 33 | 4 | 40 |
| 304G010060 | M10 | 33 | 4 | 60 |
| 304G010070 | M10 | 33 | 4 | 70 |
| 304G010080 | M10 | 33 | 4 | 80 |
| 304G010085 | M10 | 33 | 4 | 85 |
| 304G010100 | M10 | 33 | 4 | 100 |

| Art. | COLOUR |
|----------|--------|
| 15.009 | ● |
| 15.009.1 | ● |
| 15.009.2 | ● |

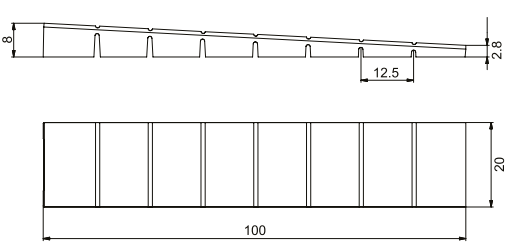

PLASTIC WEDGES
KLINY MEBLOWE

SHELF SUPPORTS
WSPORNIKI PÓŁKI



| Art. | d [mm] | l [mm] |
|----------|--------|--------|
| 12.005 | 5 | 16 |
| 12.005.2 | 4 | 16 |
| 12.005.3 | 3 | 16 |

SHELF SUPPORTS with plastic
WSPORNIKI PÓŁKI z podstawą tworzywową

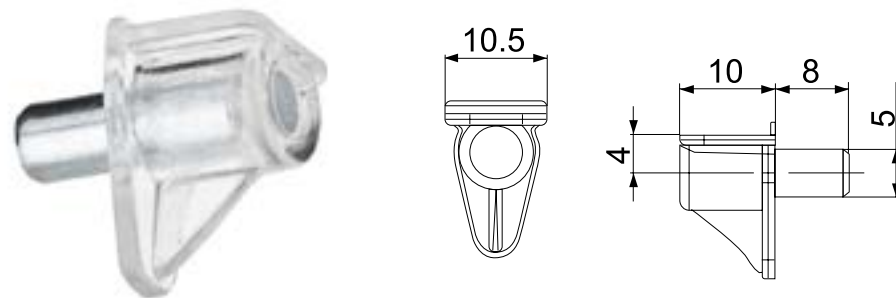

Art.
12.004

DOWEL FOR SHELF SUPPORTS
TRZPIEŃ DO ZŁĄCZA PÓŁKI

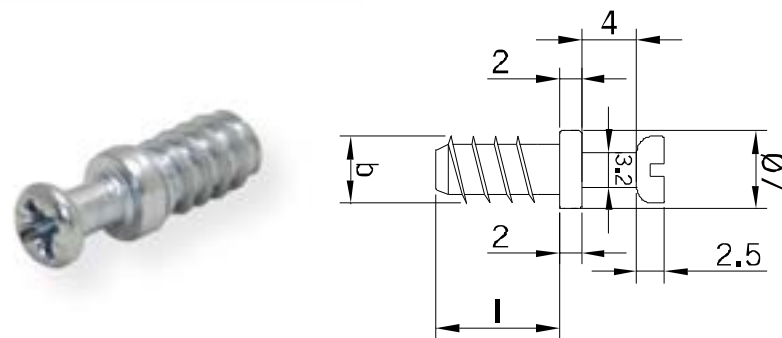

| Art. | l [mm] |
|----------|--------|
| 12.302 | 8 |
| 12.302.1 | 11 |

SHELF CONNECTORS ZŁĄCZE PÓŁKI



| Art. |  | A [mm] |
|--------|---|--------|
| 12.303 | 16 | 12,5 |
| 12.304 | 18-19 | 14 |

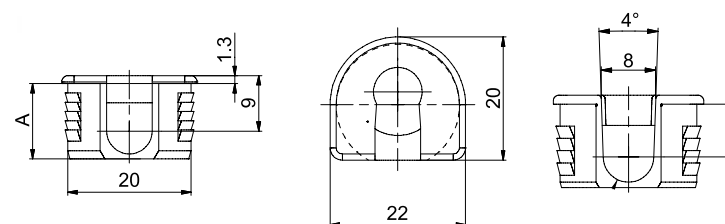

SHELF SUPPORTS
WSPORNIKI PÓŁEK



Art.
12.001

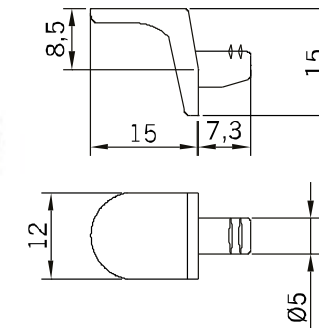

Art.
12.002

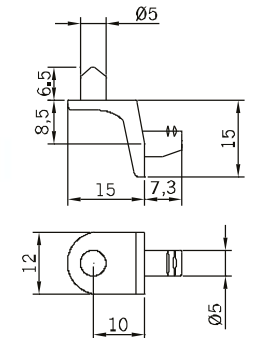
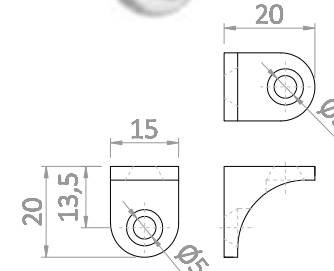
Art.
12.008

Art.
12.012

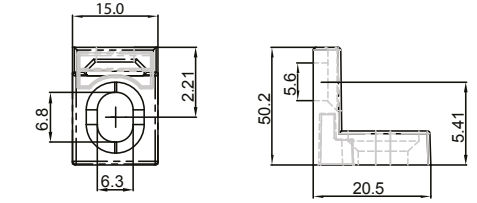

Art.
12.013

INVISIBLE SHELF HOLDER
RAMIONA NIEWIDOCZNE DO PÓŁEK

| Art. | L [mm] | L1 [mm] |
|--------|----------|---------|
| 12.201 | 9 x 90 | 50 |
| 12.202 | 9 x 140 | 50 |
| 12.203 | 10 x 100 | 72 |
| 12.204 | 10 x 145 | 72 |
| 12.205 | 12 x 70 | 48 |
| 12.206 | 12 x 120 | 72 |
| 12.207 | 14 x 120 | 72 |
| 12.208 | 14 x 140 | 75 |
| 12.209 | 14 x 165 | 75 |
| 12.210 | 14 x 200 | 77 |

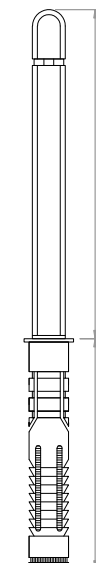

GLASS SHELF SUPPORTS
WSPORNIKI DO PÓŁEK SZKLANYCH

GLASS SHELF SUPPORTS
WSPORNIKI DO PÓŁEK SZKLANYCH

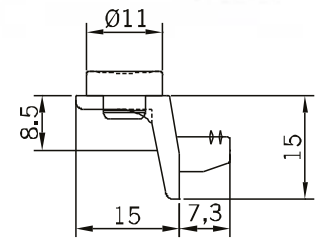

Art.
12.101

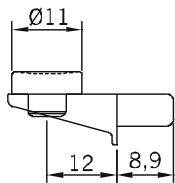

Art.
12.102

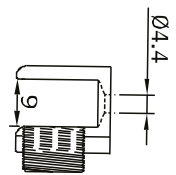

Art.
12.103

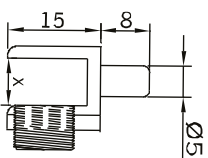

Art.
12.104



Art.
12.115

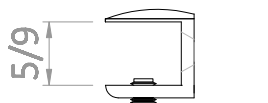

Art.
12.116

| Art. | MATERIAŁ |
|--------|----------|
| 12.109 | PE |
| 12.110 | PVC |



GLASS SHELF SUPPORTS
WSPORNIKI DO PÓŁEK SZKLANYCH

Art.
12.107

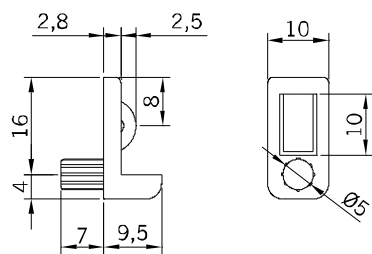

SHELF BLOCK X SHAPE WITH PIN 5 MM
BŁOKADA PÓŁKI X BOLEC 5 MM

Art.
12.400

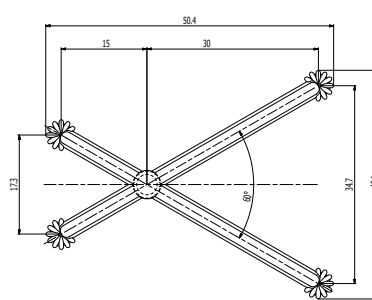

INOX DISTANCE
DYSTANS DO SZYLDÓW

| Art. | SIZE [mm] |
|--------|-----------|
| 12.450 | 12 x 20 |
| 12.452 | 16 x 33 |
| 12.458 | 19 x 25 |
| 12.453 | 19 x 45 |
| 12.455 | 25 x 73 |



INOX DISTANCE
MOCOWANIE DO SZYLDÓW

| Art. | SIZE [mm] |
|--------|-----------|
| 12.456 | 20 |
| 12.457 | 25 |

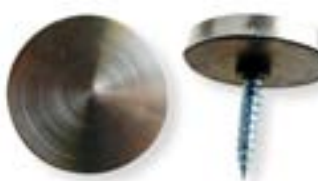

PODPÓRKI

PODPÓRKI

ADHESIVE FELT PADS
FILCE SAMOPRZYLEPNE



| Art. | Ø [mm] |
|--------|--------|
| 16.130 | 12 |
| 16.105 | 16 |
| 16.101 | 18 |
| 16.106 | 20 |
| 16.102 | 22 |
| 16.103 | 24 |
| 16.104 | 26 |
| 16.107 | 28 |
| 16.108 | 30 |
| 16.109 | 32 |
| 16.110 | 34 |
| 16.111 | 36 |
| 16.112 | 40 |
| 16.113 | 45 |
| 16.114 | 50 |
| 16.115 | 60 |

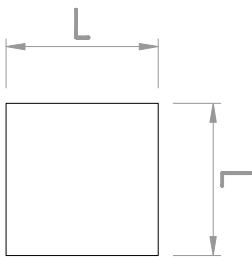
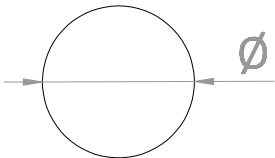

| Art. | SIZE [mm] |
|--------|------------|
| 16.116 | 20 x 20 |
| 16.117 | 25 x 25 |
| 16.118 | 30 x 30 |
| 16.119 | 35 x 35 |
| 16.120 | 40 x 40 |
| 16.121 | 45 x 45 |
| 16.122 | 50 x 50 |
| 16.126 | 100 x 100 |
| 16.128 | 300 x 200 |
| 16.129 | 100 x 1000 |
| 16.125 | 15 x 50 |
| 16.124 | 25 x 50 |
| 16.123 | 25 x 35 |

Available in other sizes and colors for customer's order
Dostępne inne wymiary i wykończenie na zamówienie klienta

ADHESIVE DOOR BUMPERS
ODBOJNIKI SAMOPRZYLEPNE



| Art. | Ø [mm] | 📦 |
|--------|-------------|----|
| 16.001 | 7 x 1,5 | 50 |
| 16.002 | 8 x 1,5 | 50 |
| 16.003 | 10 x 1,5 | 50 |
| 16.004 | 10 x 3 | 50 |
| 16.005 | 20 x 6,2 | 21 |
| 16.006 | 22,3 x 10,1 | 18 |
| 16.007 | 18 x 1 | 18 |
| 16.008 | 13 x 4 | 40 |
| 16.009 | 16,5 x 10,2 | 32 |
| 16.010 | 11,1 x 5 | 55 |
| 16.011 | 13 x 7,5 | 40 |
| 16.012 | 16 x 7,9 | 32 |
| 16.013 | 19 x 9,5 | 21 |
| 16.018 | 12,7 x 3,5 | 40 |
| 16.026 | 10 x 1 | 50 |
| 16.027 | 8 x 2,2 | 50 |

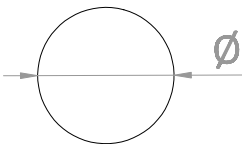

| Art. | SIZE [mm] | 📦 |
|--------|-------------------|----|
| 16.014 | 10 x 10 x 2,5 | 55 |
| 16.015 | 12 x 12 x 5,8 | 40 |
| 16.016 | 20,5 x 20,5 x 7,5 | 18 |
| 16.017 | 20 x 20 x 13,2 | 18 |

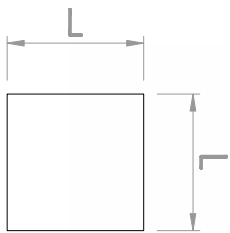

NON SLIPS MATS
MATY ANTYPOŚLIZGOWE

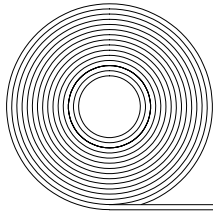

| Art. | L [mm] |
|--------|--------|
| 16.180 | 480 |
| 16.181 | 500 |

Available in other sizes and colors for customer's order
Dostępne inne wymiary i wykończenie na zamówienie klienta

ADHESIVE WALL BUFFERS
ODBOJNIKI DO ŚCIANY

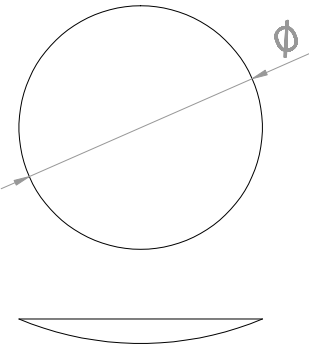

| Art. | Ø [mm] |
|--------|--------|
| 16.021 | 40 |
| 16.022 | 60 |

COVER CAPS FOR EXCENTER
ZAŚLEPKI DO MIMOŚRODÓW

| Art. |
|--------|
| 17.100 |

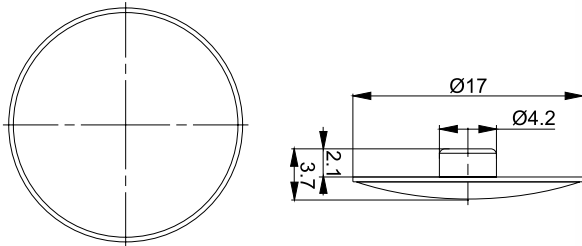

Available in other sizes and colors for customer's order
Dostępne inne wymiary i wykończenie na zamówienie klienta

COVER CAPS
ZAŚLEPKI

| Art. | Ø [mm] |
|--------|--------|
| 17.004 | 35 |
| 17.006 | 40 |

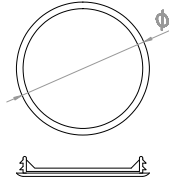

Available in other sizes and colors for customer's order
Dostępne inne wymiary i wykończenie na zamówienie klienta

WOODEN COVER CAPS
ZAŚLEPKI DREWNIANE

| WOOD | Ø 10 | Ø 15 | Ø 20 | Ø 25 | Ø 30 | Ø 35 | Ø 40 |
|-------|--------|--------|--------|--------|--------|--------|--------|
| PINE | 17.S10 | 17.S15 | 17.S20 | 17.S25 | 17.S30 | 17.S35 | 17.S40 |
| ASH | 17.J10 | 17.J15 | 17.J20 | 17.J25 | 17.J30 | 17.J35 | 17.J40 |
| BEECH | 17.B10 | 17.B15 | 17.B20 | 17.B25 | 17.B30 | 17.B35 | 17.B40 |
| OAK | 17.D10 | 17.D15 | 17.D20 | 17.D25 | 17.D30 | 17.D35 | 17.D40 |



ADHESIVE COVER CAPS
ZAŚLEPKI SAMOPRZYLEPNE

| Art. | Ø [mm] |
|-----------|--------|
| 17.201.10 | 10 |
| 17.201.14 | 14 |
| 17.201.20 | 20 |
| 17.201.40 | 40 |

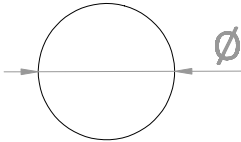

Available in other sizes and colors for customer's order
Dostępne inne wymiary i wykończenie na zamówienie klienta

GLUE IN TUBES
KLEJ W TUBKACH



| Art. | [ml] |
|-----------|------|
| 16.050.8 | 8 |
| 16.050.10 | 10 |
| 16.050.12 | 12 |
| 16.050.14 | 14 |
| 16.050.20 | 20 |
| 16.050.30 | 30 |

BEECH WOODEN DOWELS
KOŁKI DREWNIANE

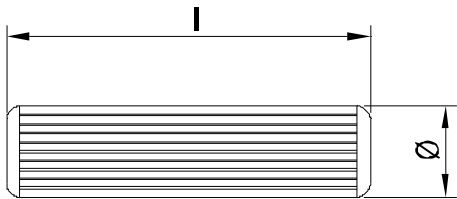

| l | Ø 8 [mm] | Ø 10 [mm] | Ø 12 [mm] |
|----|----------|-----------|-----------|
| 30 | • | | |
| 32 | • | | |
| 35 | • | • | |
| 40 | • | • | |
| 45 | | • | |
| 50 | • | • | • |
| 60 | • | | • |

OVERBALANCE PROTECTION
ZABEZPIECZENIA PRZED PRZEWRACIANIEM

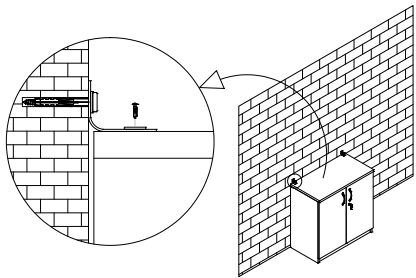

Art.
16.402

BACK STOPPER
PŁYTKI ŚCIANY TYLNEJ

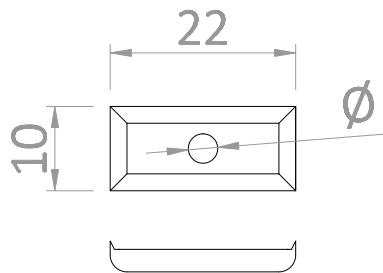

| Art. | Ø [mm] |
|----------|--------|
| 16.403.1 | 2,6 |
| 16.403.2 | 3,5 |

GLIDES WITH NAIL diam 15 mm
ŚLIZGACZE Z GWOŹDZIEM średnica 15 mm

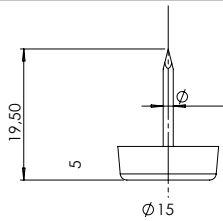

| Art. | COLOUR |
|----------|--------|
| 16.192.2 | • |
| 16.192.1 | • |
| 16.192 | • |

GLIDES WITH FELT AND SCREW
ŚLIZGACZE Z FILCEM I WKRĘTEM

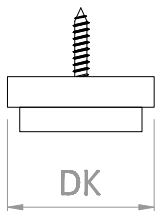

| Art. | DK [mm] | COLOUR |
|--------|---------|--------|
| 16.144 | 20 | • |
| 16.145 | 24 | • |
| 16.146 | 28 | • |

GLIDES WITH FELT AND NAIL
ŚLIZGACZE Z FILCEM I GWOŹDZIEM

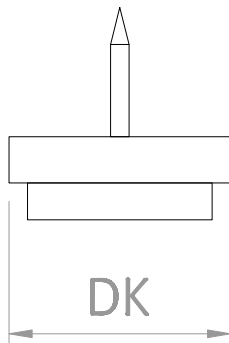

| Art. | DK [mm] | COLOUR |
|----------|---------|--------|
| 16.140 | 17 | • |
| 16.140.1 | 17 | • |
| 16.141 | 20 | • |
| 16.141.1 | 20 | • |
| 16.147 | 22 | • |
| 16.142 | 24 | • |
| 16.142.1 | 24 | • |
| 16.143 | 28 | • |
| 16.148 | 30 | • |



TELFON GLIDES WITH SCREW
ŚLIZGACZE TEFLONOWE Z WKRĘTEM

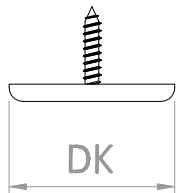

| Ø [mm] | 19 | 22 | 25 | 30 | 40 | 50 |
|--------|--------|--------|--------|--------|--------|--------|
| Art. | 16.150 | 16.151 | 16.152 | 16.153 | 16.154 | 16.155 |

TELFON GLIDES WITH NAIL
ŚLIZGACZE TEFLONOWE Z GWOŹDZIEM

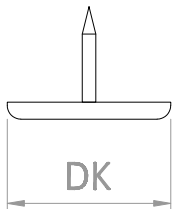

| Ø [mm] | 19 | 22 | 25 | 30 | 37 |
|--------|--------|--------|--------|--------|--------|
| Art. | 16.160 | 16.161 | 16.162 | 16.163 | 16.164 |

TABLE HINGES 6 HOLES
ZAWIASY DO STOŁU



| Art. | FINISHING |
|----------|-----------|
| 16.507.1 | NICKEL |
| 16.507.2 | BRASS |
| 16.507.3 | BRONZE |

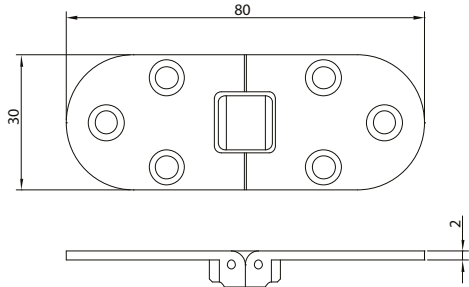

INVISIBLE HINGES, BRASS
ZAWIASY CYLINDRYCZNE

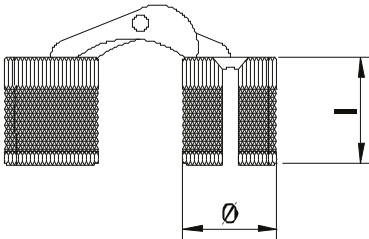

| Art. | Ø [mm] |
|--------|--------|
| 16.501 | 10 |
| 16.502 | 12 |
| 16.503 | 14 |
| 16.504 | 16 |
| 16.505 | 18 |
| 16.506 | 24 |

LOCATING PINS FOR TABLES
ZESPÓŁ NAPROWADZAJĄCY DO BLATÓW

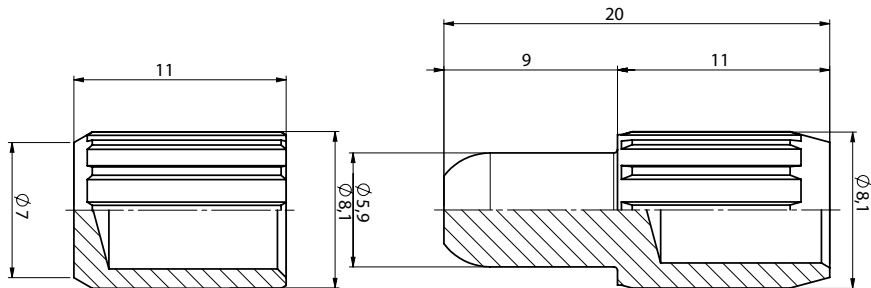

| Art. |
|-------|
| 405KT |

TABLE CATCH FITTINGS
KLAMRY DO WKŁADEK STOŁU

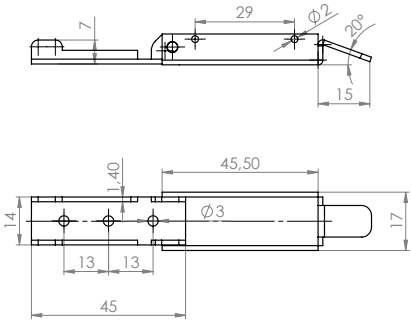

HOOK FOR TABLES
HAK SPINAJĄCY DO STOŁU

| Art. |
|--------|
| 16.512 |

| Art. |
|--------|
| 16.511 |

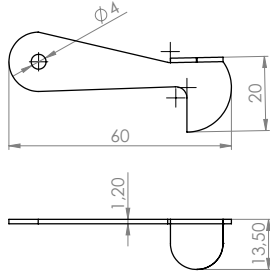

LEG CORNERS FOR TABLES
OBEJMY DO OSKRZYNY STOŁU



| Art. |
|----------|
| 16.510.4 |



| Art. |
|----------|
| 16.510.1 |



| Art. |
|--------|
| 16.510 |

